



ROTAREX
FIRETEC



OBJECT FIRE SUPPRESSION SYSTEMS
JANUARY 2020

TABLE OF CONTENTS

PRODUCT RANGE OVERVIEW	P. 004
-------------------------------	--------

TECHNOLOGY OVERVIEW	P. 008
- Sensor tube technology	P. 008
- The FIREDETEC® concept	P. 010
- Direct vs. indirect	P. 012
- DIMES	P. 013
- Extinguishing agents	P. 014
- Directional valve technology	P. 015

PRE-ENGINEERED SYSTEMS	P. 016
- Electrical cabinet systems	P. 016
· Indirect Systems	P. 016
· Direct Systems	P. 020
- CNC machinery systems	P. 022
- Fume cabinet systems	P. 024
- Commercial kitchen systems	P. 026
- Vehicle engine systems	P. 032

SPECIAL APPLICATIONS	P. 036
- Smoke detection systems	P. 036
- ABC dry chemical systems	P. 038

CYLINDER/VALVE ASSEMBLIES	P. 040
- CO ₂ system cylinder/valve assemblies	P. 040
- CO ₂ system cylinder/valve assemblies solenoid actuation	P. 041
- Cylinder/valve assemblies using NOVEC™ 1230 Fluid	P. 042
- FM-200® system cylinder/valve assemblies	P. 043
- Commercial kitchen cylinder/valve assemblies	P. 044
- Vehicle Engine cylinder/valve assemblies	P. 045
- ABC Dry Chemical cylinder/valve assemblies	P. 045

DETECTION SYSTEM ACCESSORIES	P. 046
- FireDETEC® sensor tubing	P. 046
- Switch manifold	P. 046
- Protective coils & springs	P. 047
- Attachment clips	P. 047
- Smoke detector	P. 047
- Fittings	P. 048
- End of line devices	P. 050

DISCHARGE SYSTEM ACCESSORIES	P. 051
- Discharge tubing	P. 051
- Fittings	P. 051
- Flexible hoses	P. 053
- Mounting brackets	P. 053
- Directional valves	P. 053
- Nozzles	P. 054

DIMES ACCESSORIES	P. 055
- DIMES Control & Alarm Box	P. 055
- DIMES Calibration Unit	P. 055
- DIMES Connector Cables	P. 055

OPTIONAL EQUIPMENT	P. 056
- Pressure switches	P. 056
- Alarms	P. 057
- Dashboard control box	P. 057
- Cylinder mounting brackets	P. 058
- Blocking valve unit	P. 059
- Check valve	P. 059
- Pressure gauges	P. 059
- Extinguishing agent refills	P. 060
- Cylinder labels	P. 061
- Warning labels	P. 062

INSTALLATION AND MAINTENANCE TOOLS	P. 063
- Tube cutter	P. 063
- Sensor tube gripping tool	P. 063
- Sensor tube filling adaptor	P. 063
- Sensor tube filling kit	P. 063
- Sensor tube filling/demo kit	P. 064

SPARE PARTS	P. 064
- End of line spare parts	P. 064
- Single ring fittings for 8mm tubing	P. 064
- Cylinder mounting brackets	P. 064
- Ball valves	P. 065
- Ball valve security lock	P. 065
- Gaskets	P. 065
- Pressure relief device	P. 066
- Protection cap	P. 066
- Spare parts for vehicle engine systems	P. 067

INSTALLATION GUIDELINE	P. 068
-------------------------------	--------



FireDETEC®, TRIPLESTAR®, COMPACT LINE® systems are designed according to one or more standards. Each page clearly indicates the applicable approval certification. All Rotarex manufacturing sites comply with ISO 9001-2015 quality standards.

eurofin
FA 127:16

* Components are certified only when used together in a properly configured installation
Product images are not contractual

PRE-ENGINEERED SYSTEMS

★★ **FIREDETEC**



ELECTRICAL CABINET SYSTEMS
For all electronics enclosures

P. 016

★★ **FIREDETEC**



CNC MACHINERY SYSTEMS
For all mechanical enclosures

P. 022

★★ **FIREDETEC**



FUME CABINET SYSTEMS
For all chemical handling enclosures

P. 024

★★ **TRIPLESTAR**



COMMERCIAL KITCHEN SYSTEMS
For large, medium and small - sized Kitchens

P. 026

★★ **COMPACT LINE**



VEHICLE ENGINE SYSTEMS
For all mobile vehicules

P. 032

SPECIAL APPLICATIONS



SMOKE DETECTION & SOLENOID ACTUATION P. 036



ABC DRY CHEMICAL SYSTEMS P. 038

COMPONENTS & SPARE PARTS



CYLINDER / VALVE CO₂ For IHP or DHP configurations P. 040



CYLINDER / VALVE NOVEC 1230 FLUID² For ILP or DLP configurations P.042



CYLINDER / VALVE CHEMOURS® FM-200™¹ For ILP or DLP configurations P. 043



CYLINDER / VALVE TRIPLESTAR® For commercial kitchen systems P. 044



COMPACT LINE® CYLINDER For vehicle engine systems P. 045



CYLINDER / VALVE ABC DRY CHEMICAL For ILP configurations P. 045

CONFIGURE CYLINDER/VALVE ASSEMBLIES TO YOUR NEEDS BY ORDERING COMPONENTS SEPARATELY



¹FM-200® is a trademark of Chemours, used under license.
²3M and Novec fluid are trademark of The 3M Company.

FIREDETEC® SENSOR TUBING & ACCESSORIES



SENSOR TUBING

P. 046



PRESSURE SWITCH MANIFOLD

P. 046



PROTECTIVE COILS

P. 047



SENSOR TUBE CLIPS

P. 047



SMOKE DETECTOR

P. 047



QUICK-CONNECT SENSOR TUBE FITTINGS

P. 048



STANDARD SENSOR TUBE FITTINGS

P. 048



HIGH VIBRATION SENSOR TUBE FITTINGS

P. 049



CROSS PANEL FITTINGS

P. 049

END OF LINE DEVICES & ACTUATORS



END OF LINE PLUG

P. 050



MANUAL RELEASE DEVICE

P. 050



PISTON BLOCK

P. 050



SOLENOID RELEASE DEVICE

P. 050



END OF LINE ADAPTOR

P. 050



G1/4" SOLENOID ACTUATOR

P. 050

DISCHARGE SYSTEM & ACCESSORIES



DISCHARGE TUBING

P. 051



STAINLESS STEEL FITTINGS For Stainless steel tubing

P. 051



BRASS BICONE FITTINGS

P. 052



PIPE FITTINGS

P. 052/053



HOSES

P. 053



DISCHARGE TUBE BRACKET

P. 053



DIRECTIONAL VALVES

P. 053



NOZZLES

P. 054

DIMES



DIMES ACCESSORIES P. 055

OPTIONAL EQUIPMENT



PRESSURE SWITCH P. 056



PRESSURE SWITCH P. 056



ALARMS P. 056



DASHBOARD WARNING DEVICE P. 057



BLOCKING VALVE UNIT P. 059



CYLINDER MOUNTING BRACKETS P. 058



CHECK VALVE P. 059



PRESSURE GAUGES P. 059



EXTINGUISHING AGENT REFILL P. 060



LABELS P. 061

INSTALLATION AND MAINTENANCE TOOLS



SENSOR TUBE CUTTER P. 063



SENSOR TUBE GRIPPING TOOL P. 063



SENSOR TUBE FILLING ADAPTOR P. 063



SENSOR TUBE FILLING KIT P. 063



COMPACT LINE® FILLING KIT P. 063



SENSOR TUBE FILLING / DEMO KIT P. 064

SPARE PARTS



SPARE PARTS P. 064

THE SENSOR TUBE TECHNOLOGY

Rotarex FireDETEC® systems use a proprietary continuous linear sensor tube that reliably detects and actuates release of the extinguishing agent using pneumatic technology. It is more flexible, space efficient and cost effective versus alternative mechanical or electronic systems. The revolutionary pneumatic design enables cost-effective protection of individual high-risk areas like electrical and mechanical equipment that were previously not practical to protect.

1. Installation closer to the source

Because the sensor tubing is flexible, it can easily be installed directly inside machines and enclosures – directly among circuitry and mechanics.

When in service, the tubing is pressurized with dry nitrogen under 240 psi / 16 bar of pressure. The dynamics of pressurization make the tubing more reactive to heat.



2. Early fire detection

The heat that immediately precedes or accompanies a fire causes the pressurized sensor tube to burst at the hottest spot.

3. Instant Suppression

The sudden tube depressurization actuates the special valve and floods the enclosed area with extinguishing agent. The fire is quickly suppressed just moments after it began ... minimizing damage and repair downtime.



UL approved sensor tube



Exceptionally durable:

- 5 + year service lifetime
- Low porosity
- Can withstand high cycle temperatures
- UV resistant option available



THE SENSOR TUBE TECHNOLOGY

3 TYPES OF TUBING FOR BEST PERFORMANCE

	All-Purpose Tubing	Special Applications	Kitchen Systems
			
APPLICATION:	For all applications	Multi-layer construction is more resistant to temperature extremes, chemical agents and UV	Specifically designed to withstand heat and grease conditions above kitchen cooking areas
IDEAL FOR:	<ul style="list-style-type: none"> - Electrical Cabinets - Relay boxes - CNC Machines - Construction Machinery - Agricultural Machines 	<ul style="list-style-type: none"> - Laboratory fume hoods - Chemical storage areas - Petroleum storage tanks - Hydraulic equipment - Vehicle engines 	<ul style="list-style-type: none"> - Professional Kitchens - Zones at risk for grease fire
Burst Temperature	110° C	110° C	175° C
Color	Red RAL 3000	Black RAL 9005	Grey RAL 7042
Min. Bend Radius	100 mm	150 mm	150 mm
Working temp	-30°C to 80°C	-30°C to 80°C	-30°C to 90°C



THE FIREDETEC® CONCEPT

THE NEW KIND OF FIRE SUPPRESSION SYSTEM THAT INSTALLS DIRECTLY INSIDE INDIVIDUAL HIGH RISK MACHINERY OR EQUIPMENT – CLOSER TO WHERE A FIRE COULD START.

IDEAL FOR:

SUPPLEMENTAL PROTECTION FOR CRITICAL HIGH-RISK EQUIPMENT:



ELECTRICAL CIRCUITRY

- Electrical Cabinets
- Control Boxes
- Recharging stations
- Switch panels
- Relay stations



MACHINERY

- CNC machines
- Construction machinery
- Agricultural machines



OILS, CHEMICALS AND OPEN FLAME

- Fume Cabinets
- Paint & Chemical storage
- Petroleum storage tanks
- Hydraulic circuits



ATM



WIND TURBINES

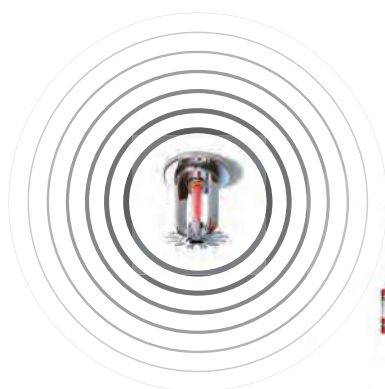

PROTECTS THE GAP BETWEEN CONVENTIONAL FIRE PROTECTION SYSTEMS

**24/7 PROTECTION:**

Automatically detects and suppresses fires at the source.

**PLUG & PLAY SIMPLICITY:**

Systems and kits are pre-configured according to most recognized European or international standards with plug & play simplicity. No complex electronics.

**FAST AND EFFECTIVE:**

Rapid reaction as soon as a fire starts, before it can damage equipment and before the sprinkler system activates. Safe against malfunction.

**HIGHLY ECONOMICAL:**

Outstanding cost-performance ratio.

DIRECT AND INDIRECT CONFIGURATIONS



DIRECT SYSTEM

Extinguishing agent is discharged through the burst hole in the sensor tube.

Used for:

Very small enclosed space and hard to reach areas < 2m³ (under certain conditions)

Advantages:

- More economical
- Easiest-to-install
- Ideal for multiple separated units



INDIRECT SYSTEM

Extinguishing agent is discharged through a separate delivery nozzle.

Used for:

All Enclosed spaces

Advantages:

- Most effective fire suppression
- Covers a large area
- Allows quicker discharge of extinguishing agent
- Works with all suppression agents
- Manual actuation possible



Improve productivity and safety with a Digital Measurement System - available as an option for all CO₂ indirect systems.

SIGNIFICANT ADVANTAGES:

- Certainty that your system is charged and ready: Continually monitors cylinder pressure and system readiness. In case of a leak, the system can send an audio and visual warning signal.
- Eliminates the need to periodically dismount and weigh cylinders to verify fill levels.
- Electronic circuitry permits to connect peripheral electronic devices



DIMES valves contain a micro chip that permits calibration of the system to the cylinder of valves. A calibration unit is required (see page 55).



DIMES ELECTRONICALLY MEASURES THE CO₂ DENSITY IN THE CYLINDER

The capacitance between two electrodes changes as the CO₂ density changes. This generates a digital signal that can be transmitted to an alarm box, digital readout device, or telemetrically to a remote location.



Control alarm box

Indicates that system is properly armed and sounds audio alarm when the system actuates



Calibration unit

Calibrates the valve to the cylinder using a built-in computer chip



Pressure switch

recommended to:

- monitor system status
- Transmit alarm signals
- send an electronic shut-down signal

TECHNICAL CHARACTERISTICS OF DIMES - ELECTRONIC

Supply voltage	6 to 30 VDC	
Temperature range	- 20°C to + 60°C	
Alarm level	80 % (configurable)	
Max. switching power	20 W	
Max. contact rating	0,4 A	
Max. switching voltage	50 V	
Sealed housing	IP 67	
Max. dissipation rating	6 mA	
Max. dissipation power	12 VDC	24 VDC
	72 mW	144 mW

EXTINGUISHING AGENTS

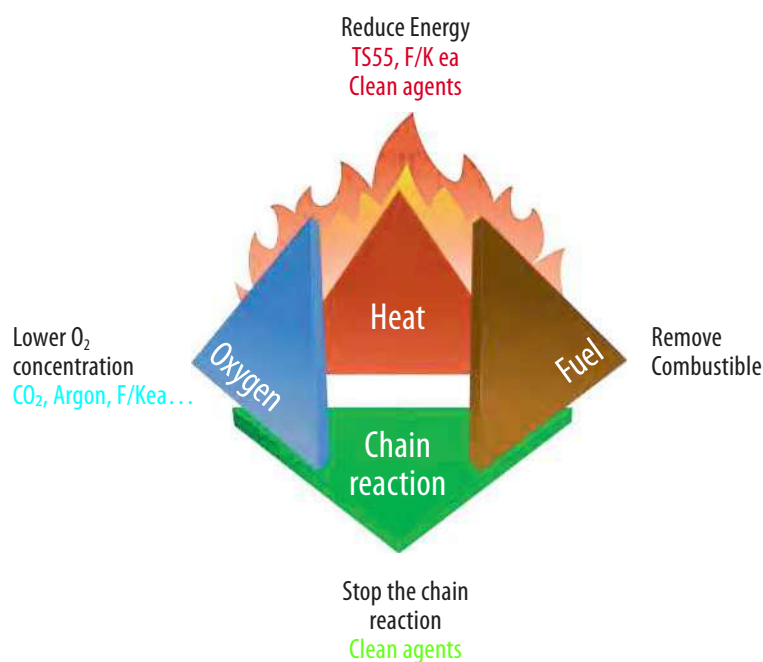

FIRE CLASSES & EXTINGUISHING AGENT CHOICE

Europe	Australia	USA	Combustible	CO ₂	Inert Gas	FM-200™ HFC-227	Novec 1230 Fluid	TS55	F/K ea	ABC dry chemical
Class A	Class A	Class A	Fires involving ordinary combustible (wood, paper, cloth, trash, plastics...)	±	±	±	✓	✓	✓	✓
Class B	Class B	Class B	Fires involving flammable liquids or liquefiable solids (petrol, oil, paint...)	✓	✓	✓	✓	×	×	✓
Class C	Class C		Fires involving flammable gases (natural gas, hydrogen, propane, butane...)	✓	✓	✓	✓	×	×	✓
Class D	Class D	Class D	Fires involving combustible metals (sodium, magnesium, and potassium...)	×	×	×	×	×	×	×
	Class E	Class C	Fires involving electrical devices, and energized electrical equipment (anything that is plugged in)	✓	✓	✓	✓	×	×	✓
Class F	Class F	Class K	Fires involving commercial cooking fats and oils	±	±	±	±	×	✓	✓
			Fire involving vehicles (oils, plastics, hydrocarbon, ...)	±	±	±	±	✓	±	✓

All informations is non - contractual subjected to the real conditions of use / elements to be protected

DIRECTIONAL VALVE TECHNOLOGY FOR CO₂ SYSTEMS

The efficient and economical way to protect multiple zones with the same cylinder/valve. FireDETEC Directional Valves allow you to isolate separate protection zones within a single system - with absolutely no loss of efficacy.



HOW IT WORKS:

EACH PROTECTION ZONE IS EQUIPPED WITH A DIRECTIONAL VALVE.

The directional valve is closed when the system is armed. In the event of a fire in one of the local zones, the FireDETEC sensor tube bursts and the directional valve opens. This also actuates the main system discharge. The discharge is routed through the open directional valve and discharges only in the zone where there is a fire. The other directional valves remain closed.

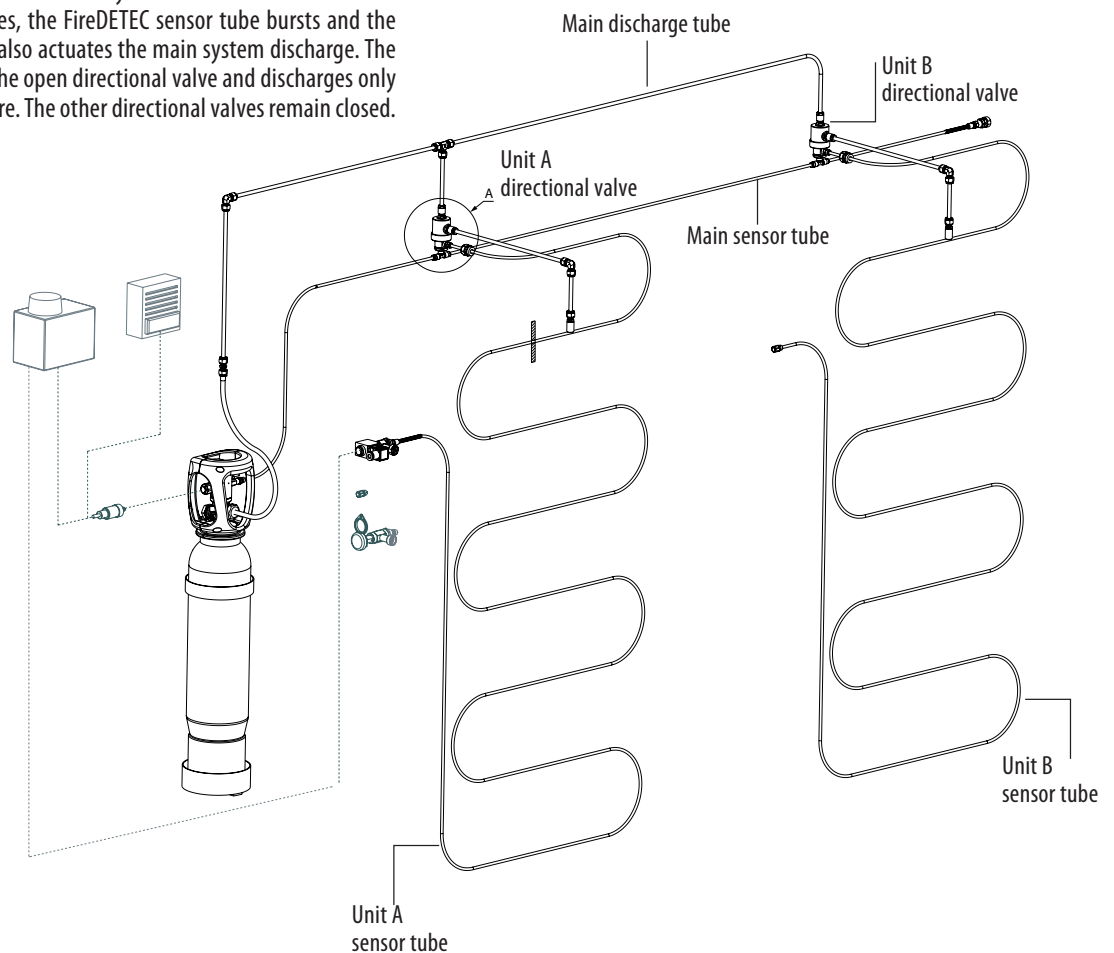

ELECTRICAL CABINET SYSTEMS - INDIRECT

A complete preengineered system for electrical cabinets and other enclosed areas with electric circuitry.



Everything you need together in one box

DIMES option available



5 Kg. / 10 Kg.



Direct systems available (see page 20)

Optional :



Alarms p.56



Pressure switch p.56

MINIMIZES RISK TO VITAL EQUIPMENT

- #1 Cause of Industrial Fires*
- 75% of total-loss fires start as an electrical fire*
- Helps minimize damage to vital electrical equipment
- Minimizes work stoppage during repairs/cleanup
- Prevents extensive cleanup if the sprinkler system discharges

KEY FEATURES

- A complete, ready-to-install system - all in one box
- Available with CO₂ or HFC-227ea extinguishing agent
- Available in multiple cylinder sizes for small, medium or large enclosures
- CO₂ systems available with choice of filled or unfilled cylinders
- HFC-227ea systems available empty only

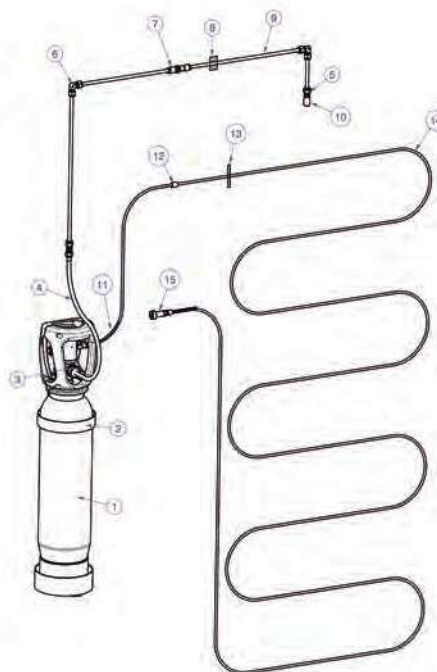

*NFPA statistics

SYSTEM CONTENTS - CO₂COMPLETE CO₂ SYSTEMS

POS.	QTY.	CODE	DESCRIPTION 5 KG.
1	1	B07024001	IHP Cylinder / valve assembly
2	1	024900390	Cylinder bracket
3	1	024100013	Gasket
4	1	B06920006	Rubber hose
5	1	B07835026	Tube fitting - straight
6	2	B07835028	Tube fitting - Elbow
7	1	B07835037	Cross panel-fitting
8	4	B07860006	Pipe bracket (Ø 8mm)
9	2	022700599	Stainless steel tubing (1m)
10	1	026200116	Nozzle
11	1	024920013	Protection Spring top
12	1	B07830005	Cross panel-fitting
13	20	B07860004	Binding ties
14	1	B07800015	FireDETEC® Tube red (10m)
15	1	B07810014	End of line gauge

Contents may vary according to cylinder sizes

SPECIFICATIONS

	COMPLETE CO ₂ SYSTEMS	
Product code unfilled	B07504000	B07504004
Product code filled	B07504500	B07504504
Agent capacity	5 Kg.	10 Kg. Ø204mm
Number of nozzles	1	2
Cylinder volume	6.7 liters	13.4 liters
Cylinder approval	π	π
Operating Temperature	-20°C to 60°C	-20°C to 60°C
Working pressure	60 bar at 20°C	60 bar at 20°C
Siphon tube	Yes	Yes
Sensor tubing color	Red	Red

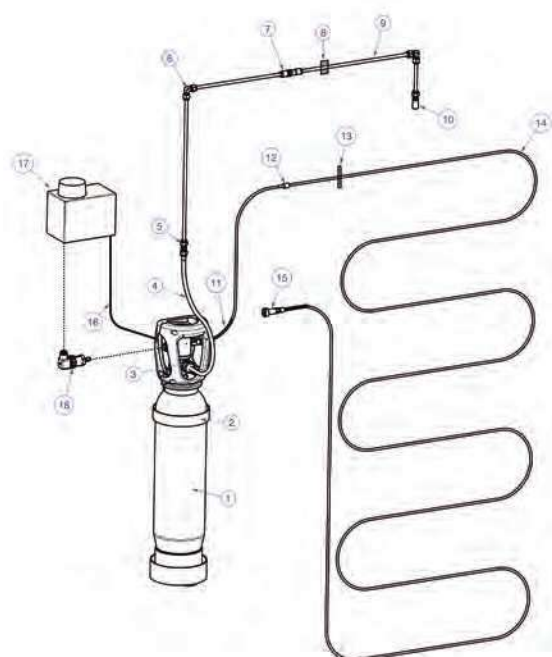
COMPLETE CO₂ SYSTEM with DIMES

POS.	QTY.	CODE	DESCRIPTION 5 KG.
1	1	B07025001	IHP Cylinder / valve assembly
2	1	024900390	Cylinder bracket
3	1	024100013	Gasket
4	1	B06920006	Rubber hose
5	1	B07835026	Tube fitting - straight
6	2	B07835028	Tube fitting - Elbow
7	1	B07835037	Cross panel-fitting
8	4	B07860006	Pipe bracket (Ø 8mm)
9	2	022700599	Stainless steel tubing (1m)
10	1	026200116	Nozzle
11	1	024920013	Protection Spring top
12	1	B07830005	Cross panel-fitting
13	20	B07860004	Binding ties
14	1	B07800015	FireDETEC® Tube red (10m)
15	1	B07810014	End of line gauge
16	1	029900088	Connector + cable for DIMES
17	1	B07850201	Control box
18	1	028255048	Pressure switch

Contents may vary according to cylinder sizes

SPECIFICATIONS

	COMPLETE CO ₂ SYSTEM with DIMES	
Product code unfilled	B07505000	B07505004
Product code filled	B07505500	B07505504
Agent capacity	5 Kg.	10 Kg. Ø204mm
Number of nozzles	1	2
Cylinder volume	6.7 liters	13.4 liters
Cylinder approval	π	π
Operating Temperature	-20°C to 60°C	-20°C to 60°C
Working pressure	60 bar at 20°C	60 bar at 20°C
Siphon tube	Yes	Yes
Sensor tubing color	Red	Red

SYSTEM CONTENTS - HFC-227 ea



HFC-227 ea SYSTEMS

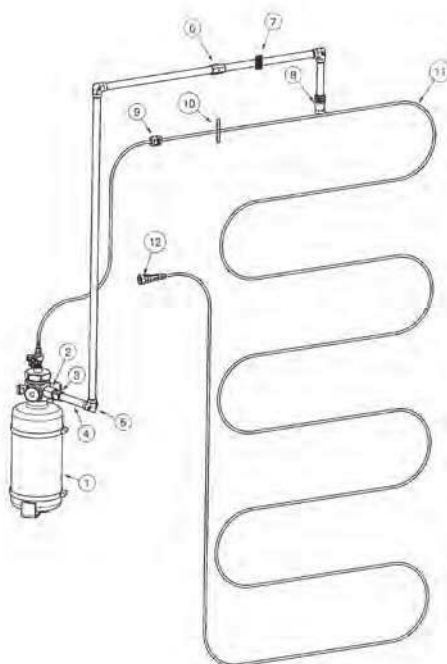

POS.	QTY.	CODE	DESCRIPTION 7 LB. 1 NOZZLE
1	1	B07014014	ILP cylinder / valve assembly
2	1	B07833003	Union fitting
3	1	B07833004	Reducing fitting
4	4	022700611	Steel pipe 3/8" sch 40 (1m)
5	3	B07833005	Elbow fitting
6	4	B07833006	Straight fitting
7	4	B07860008	Pipe bracket
8	1	026200104	Nozzle
9	1	B07830005	Cross panel-fitting
10	20	B07860004	Binding ties
11	1	B07800015	FireDETEC® Tube red (10m)
12	1	B07810026	End of line adaptor

Contents may vary according to cylinder sizes

SPECIFICATIONS

	HFC 227 ea SYSTEMS				
Product code unfilled	B07506003	B07506004	B07506006	B07506005	B07506007
Agent capacity	1,36 Kg. / 3 lbs.	3,18 Kg. / 7 lbs.	3,18 Kg. / 7 lbs.	6,35 Kg. /14 lbs.	6,35 Kg. /14 lbs.
Number of nozzles	1	1	2	1	2
Cylinder volume	75 in ³	174 in ³	174 in ³	350 in ³	350 in ³
Cylinder approval	CE	CE	CE	CE	CE
Operating Temperature	-20°C to 60°C	-20°C to 60°C	-20°C to 60°C	-20°C to 60°C	-20°C to 60°C
Working pressure	16 bar at 20°C	16 bar at 20°C	16 bar at 20°C	16 bar at 20°C	16 bar at 20°C
Siphon tube	Yes	Yes	Yes	Yes	Yes
Sensor tubing color	Red	Red	Red	Red	Red

ELECTRICAL CABINET SYSTEMS - DIRECT

A complete preengineered system for small electrical cabinets (<2m³) and other enclosed areas with electric circuitry.



Everything you need together in one box



Indirect configurations for larger enclosures (see page 16)

MINIMIZES RISK TO VITAL EQUIPMENT

- #1 Cause of Industrial Fires*
- 75% of total-loss fires start as an electrical fire*
- Helps minimize damage to vital electrical equipment
- Minimizes work stoppage during repairs/cleanup
- Prevents extensive cleanup if the sprinkler system discharges

KEY FEATURES

- A complete, ready-to-install system - all in one box
- Available with CO₂ or HFC-227ea extinguishing agent
- Available in multiple cylinder sizes for small or medium enclosures
- HFC-227ea systems available empty only
- CE approved cylinders only



*NFPA statistics

SYSTEM CONTENTS

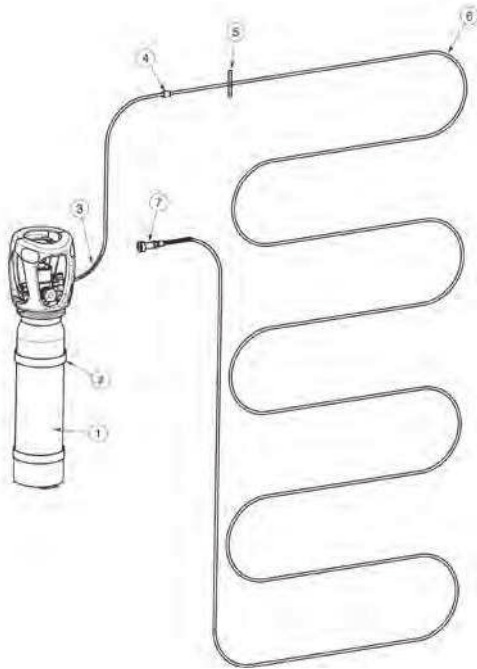
CO₂ SYSTEMS

POS.	QTY.	CODE	DESCRIPTION 2 KG.
1	1	B07034000	DHP cylinder / valve assembly (not filled)
2	1	024900399	Cylinder bracket
3	1	024920013	Protection spring top
4	1	B07830005	Cross panel-fitting
5	20	B07860004	Binding ties
6	1	B07800015	FireDETEC® tube red (10 m)
7	1	B07810014	End of line gauge

Contents may vary according to cylinder sizes

HFC-227 ea SYSTEMS

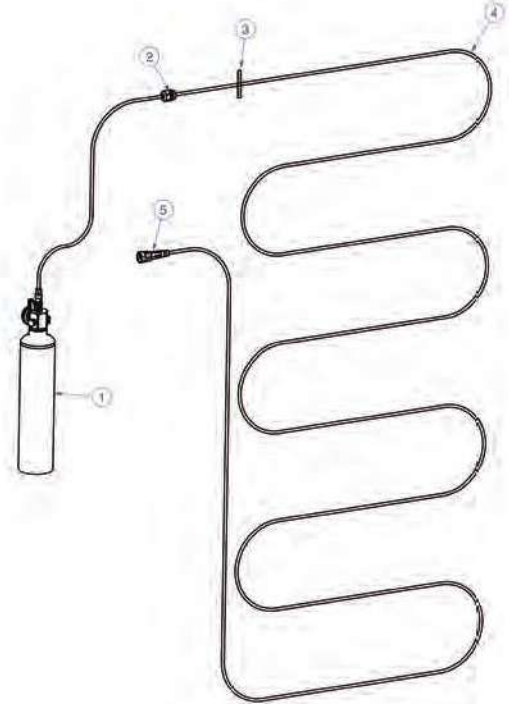

POS.	QTY.	CODE	DESCRIPTION 3 LB. CE
1	1	B07004004	DLP cylinder/valve assembly (not filled) with bracket
2	1	B07830005	Cross-panel fitting
3	20	B07860005	Binding ties
4	1	B07800015	FireDETEC® sensor tubing red (10m)
5	1	B07810026	End-of-line gauge

Contents may vary according to cylinder sizes

SPECIFICATIONS

	CO ₂ SYSTEMS	
Product code unfilled	B07502001	B07502003
Product code filled	B07502501	B07502503
Agent capacity	2 Kg.	5 Kg.
Number of nozzles	0	0
Cylinder volume	2,7 L	6,7 L
Cylinder approval	π	π
Operating Temperature	-20°C to 60°C	-20°C to 60°C
Working pressure	60 bar at 20°C	60 bar at 20°C
Siphon tube	Yes	Yes
Sensor tubing color	Red	Red

	HFC-227 ea SYSTEMS	
	B07507004	B07507005
	1,36 Kg. / 3 lbs.	3,18 Kg. / 7 lbs.
	0	0
	75 in ³	174 in ³
	CE	CE
	-20°C to 60°C	-20°C to 60°C
	16 bar at 20°C	16 bar at 20°C
	Yes	Yes
	Red	Red

CNC MACHINE SYSTEMS

A complete preengineered system for CNC Machines and other enclosed areas with mechanical or electrical components.



Everything you need together in one box

DIMES option available



5 Kg. / 10 Kg.

Optional :



Pressure switch manifold p.46

Optional :



Blocking valve unit B05513010 p.59

MINIMIZES RISK TO VITAL EQUIPMENT

- 66% of industrial fires begin on the shop floor*
- EU Machinery Directive 2006 42EC requires certain machines to be fitted with a built-in fire extinguishing system
- Helps minimize damage to vital production equipment
- Minimizes work stoppage during repairs/cleanup
- Prevents extensive cleanup if the sprinkler system discharges

KEY FEATURES

- A complete, ready-to-install system - all in one box
- Available with CO₂ extinguishing agent
- Available in multiple cylinder sizes for small or medium enclosures
- CO₂ systems available with choice of filled or unfilled cylinders
- Manual actuator included
- Protection spring included to protect sensor tubing from shocks and hot metal chips

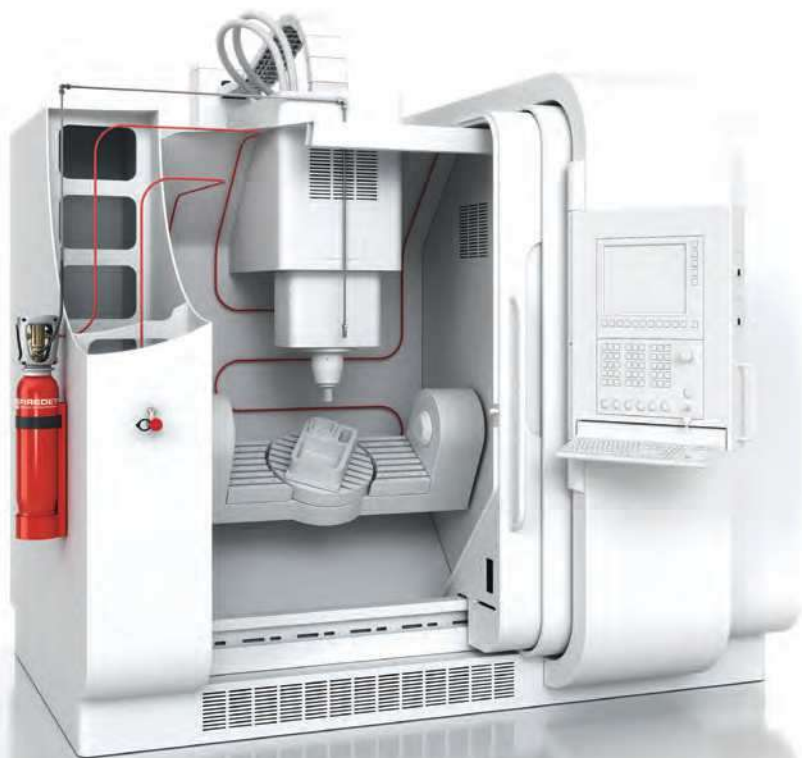

Key causes of CNC machines fires:

- Coolant malfunction
- Tool breakage
- High friction
- Static electricity
- Combustion of oil residues
- Poor maintenance
- Operator error

*NFPA statistics

SYSTEM CONTENTS

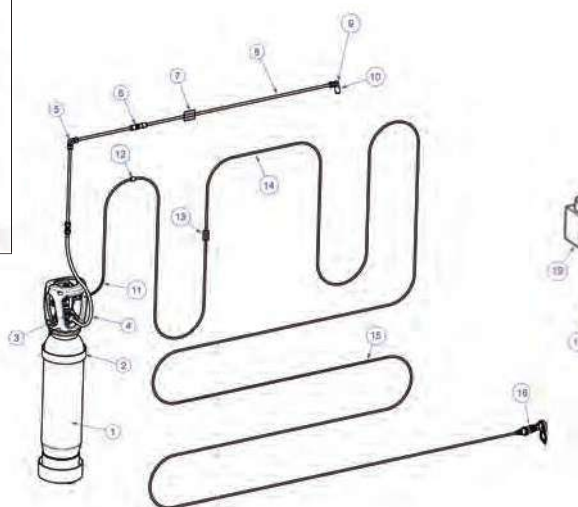
COMPLETE CO₂ SYSTEM

POS.	QTY.	CODE	DESCRIPTION 5 KG.
1	1	B07024001	IHP cylinder/valve assembly
2	1	024900390	Cylinder bracket
3	1	024100013	Gasket
4	1	B06920006	Rubber hose
5	1	B07835028	Double ring fitting - elbow 8mm
6	1	B07835037	Double ring fitting - Cross-panel straight
7	6	B07860006	Pipe bracket 8mm
8	3	022700599	8mm Stainless steel tubing (1 m)
9	1	B07835036	Double ring fitting - elbow G $\frac{1}{4}$ " - 8mm
10	1	026200116	Nozzle
11	1	024920013	Protection spring top
12	1	B07830005	Cross-panel fitting
13	20	B07860002	Screwed clips for sensor tube attachment
14	1	B07800015	FireDETEC® Tube red (10m)
15	1	B07850030	Protection spring for sensor tubing
16	1	B04420115	Manual release device

Contents may vary according to cylinder sizes

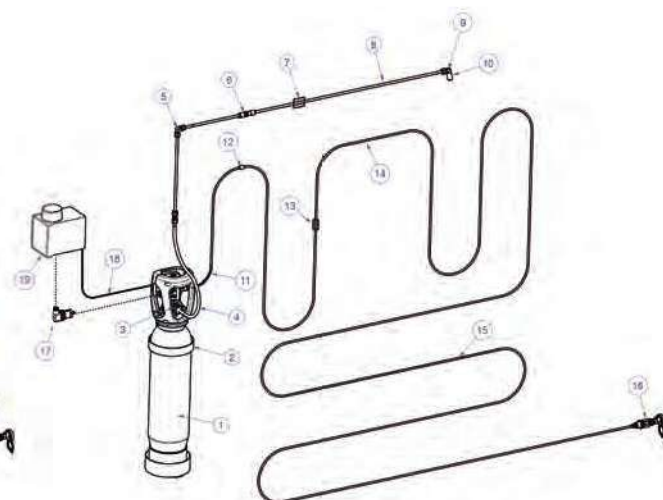
COMPLETE CO₂ SYSTEM with DIMES

POS.	QTY.	CODE	DESCRIPTION 5 KG.
1	1	B07025001	IHP cylinder/valve assembly
2	1	024900390	Cylinder bracket
3	1	024100013	Gasket
4	1	B06920006	Rubber hose
5	1	B07835028	Double ring fitting - elbow 8mm
6	1	B07835037	Double ring fitting - Cross-panel straight
7	6	B07860006	Pipe bracket 8mm
8	3	022700599	8mm Stainless steel tubing (1 m)
9	1	B07835036	Double ring fitting - elbow G $\frac{1}{4}$ " - 8mm
10	1	026200116	Nozzle
11	1	024920013	Protection spring top
12	1	B07830005	Cross-panel fitting
13	20	B07860002	Screwed clips for sensor tube attachment
14	1	B07800015	FireDETEC® sensor tubing red (10m)
15	1	B07850030	Protection spring for sensor tubing
16	1	B04420115	Manual release device
17	1	028255048	Pressure Switch
18	1	029900088	Connector + Cable for DIMES
19	1	B07850201	DIMES Control Box

Contents may vary according to cylinder sizes

SPECIFICATIONS

	COMPLETE CO ₂ SYSTEM	
Product code unfilled	B07504002	B07504003
Product code filled	B07504502	B07504503
Agent capacity	5 Kg.	10 Kg. Ø204mm
Number of nozzles	1	2
Cylinder volume	6.7 liters	13.4 liters
Cylinder approval	π	π
Operating Temperature	-20°C to 60°C	-20°C to 60°C
Working pressure	60 bar at 20°C	60 bar at 20°C
Siphon tube	Yes	Yes
Sensor tubing color	Red	Red

	COMPLETE CO ₂ SYSTEM with DIMES	
	B07505002	B07505003
	B07505502	B07505503
Agent capacity	5 Kg.	10 Kg. Ø204mm
Number of nozzles	1	2
Cylinder volume	6.7 liters	13.4 liters
Cylinder approval	π	π
Operating Temperature	-20°C to 60°C	-20°C to 60°C
Working pressure	60 bar at 20°C	60 bar at 20°C
Siphon tube	Yes	Yes
Sensor tubing color	Red	Red

FUME CABINET SYSTEMS

A complete preengineered system for Fume Cabinets and other enclosed chemical storage areas.



Everything you need together in one box

DIMES option available



5 Kg. / 10 Kg.

Optional :



Pressure switch manifold p.46

MINIMIZES RISK TO VITAL EQUIPMENT

- High incidence of fire in lab environments due to exposure of chemicals to open flame
- Extraction fan draws flames into hood where they can ignite other chemical residues
- Helps prevent technician injury
- Helps minimize damage to vital laboratory equipment
- Minimizes lab stoppage during repairs/cleanup
- Prevents extensive cleanup if the sprinkler system discharges

KEY FEATURES

- A complete, ready-to-install system - all in one box
- Available with CO₂ extinguishing agent
- Available in multiple cylinder sizes for small or medium enclosures
- Manual actuator included
- Protection spring included to protect sensor tubing from shocks and hot metal chips



*Red tubing for visualization only.
System is installed with black tubing

Key causes of Laboratory Fume Hood fires:

- Open Flame
- Flammable chemicals
- Technician error
- Combustion of chemical residues in extraction hood

SYSTEM CONTENTS

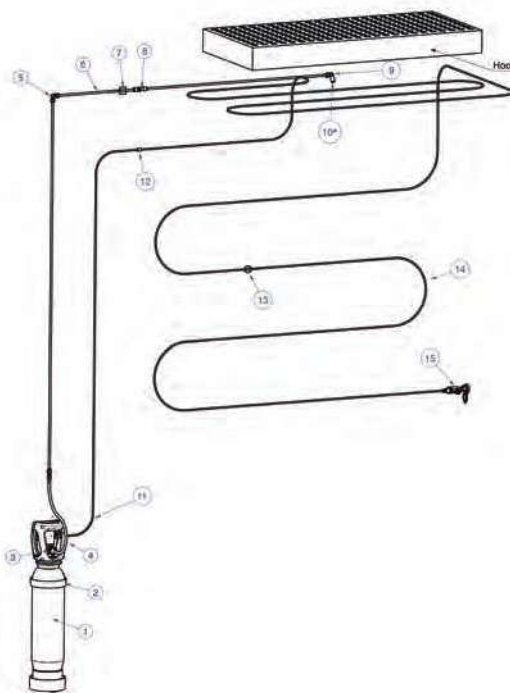
COMPLETE CO₂ SYSTEM

POS.	QTY.	CODE	DESCRIPTION 5 KG.
1	1	B07024001	IHP cylinder/valve assembly
2	1	024900390	Cylinder bracket
3	1	024100013	Gasket
4	1	B06920006	Rubber Hose
5	1	B07835028	Double ring fitting - elbow 8mm
6	1	B07835037	Double ring fitting - Cross-panel straight
7	6	B07860006	Pipe bracket 8mm
8	3	022700599	8mm Stainless steel tubing (1 m)
9	1	B07835036	Double ring fitting - elbow G $\frac{1}{4}$ " - 8mm
10	1	026200116	Nozzle
11	1	024920013	Protection spring top
12	1	B07830005	Cross-panel fitting
13	20	B07860005	Self-adhesive binding ties
14	1	B07800202	FireDETEC® sensor tubing black (10m)
15	1	B04420115	Manual release device

Contents may vary according to cylinder sizes

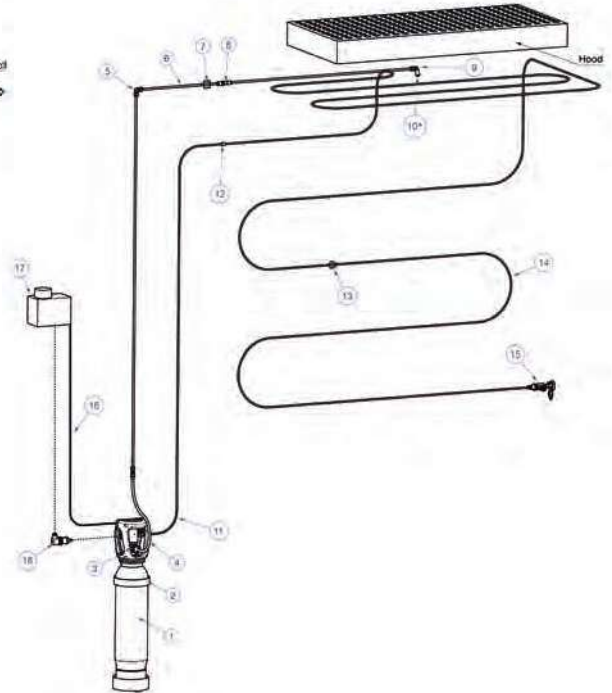
COMPLETE CO₂ SYSTEM with DIMES

POS.	QTY.	CODE	DESCRIPTION 5 KG.
1	1	B07025001	IHP cylinder/valve assembly - DIMES
2	1	024900390	Cylinder bracket
3	1	024100013	Gasket
4	1	B06920006	Rubber Hose
5	1	B07835028	Double ring fitting - elbow 8mm
6	1	B07835037	Double ring fitting - Cross-panel straight
7	6	B07860006	Pipe bracket 8mm
8	3	022700599	8mm Stainless steel tubing (1 m)
9	1	B07835036	Double ring fitting - elbow G $\frac{1}{4}$ " - 8mm
10	1	026200116	Nozzle
11	1	024920013	Protection spring top
12	1	B07830005	Cross-panel fitting
13	20	B07860005	Self-adhesive binding ties
14	1	B07800202	FireDETEC® sensor tubing black (10m)
15	1	B04420115	Manual release device
16	1	029900088	Connector + Cable for DIMES
17	1	B07850201	DIMES Control Box
18	1	028255048	Pressure Switch

Contents may vary according to cylinder sizes

SPECIFICATIONS

	COMPLETE CO ₂ SYSTEM	
Product code unfilled	B07504001	B07504005
Product code filled	B07504501	B07504505
Agent capacity	5 Kg.	10 Kg. Ø204 mm
Number of nozzles	1	2
Cylinder volume	6,7 L	13,4 L
Cylinder approval	π	π
Operating Temperature	-20°C to 60°C	-20°C to 60°C
Working pressure	60 bar at 20°C	60 bar at 20°C
Siphon tube	Yes	Yes
Sensor tubing color	Black	Black

	COMPLETE CO ₂ SYSTEM with DIMES	
Product code unfilled	B07505001	B07505005
Product code filled	B07505501	B07505505
Agent capacity	5 Kg.	10 Kg. Ø204 mm
Number of nozzles	1	2
Cylinder volume	6,7 L	13,4 L
Cylinder approval	π	π
Operating Temperature	-20°C to 60°C	-20°C to 60°C
Working pressure	60 bar at 20°C	60 bar at 20°C
Siphon tube	Yes	Yes
Sensor tubing color	Black	Black



COMPLETE FIRE SUPPRESSION SYSTEMS FOR COMMERCIAL KITCHENS

- ★ Easy / Flexible installation
- ★ Quick & Effective suppression
- ★ Highly Dependable: no electricity or moving parts
- ★ Reduces even the most critical kitchen fire risks
- ★ Kitchen Fire Suppression System tested and certified by LPCB



Piston block actuator
(see p. 50)



Stainless steel protection cabinet
(see p. 58)

Optional :



Alarms p.56

Pressure switch p.56



Optional :



Pressure switch manifold p.46



MINIMIZES RISK TO VITAL EQUIPMENT

- High incidence of fire in grill and fryer areas
- Extraction fan draws flames into hood where they can ignite other oily residues
- Helps prevent personnel injury
- Helps minimize damage to vital cooking equipment and surrounding areas
- Minimizes service stoppage during repairs/cleanup and loss of customer goodwill

KEY FEATURES

- All system components available at Rotarex, one single supplier
- Available with liquid-based FireDETEC® F/K extinguishing agent
- Manual actuator included
- Supplied with robust grey FireDETEC® sensor tubing to withstand higher ambient temperatures
- Kitchen systems cylinders are standardly delivered unfilled
- Systems delivered with F/K extinguishing agent

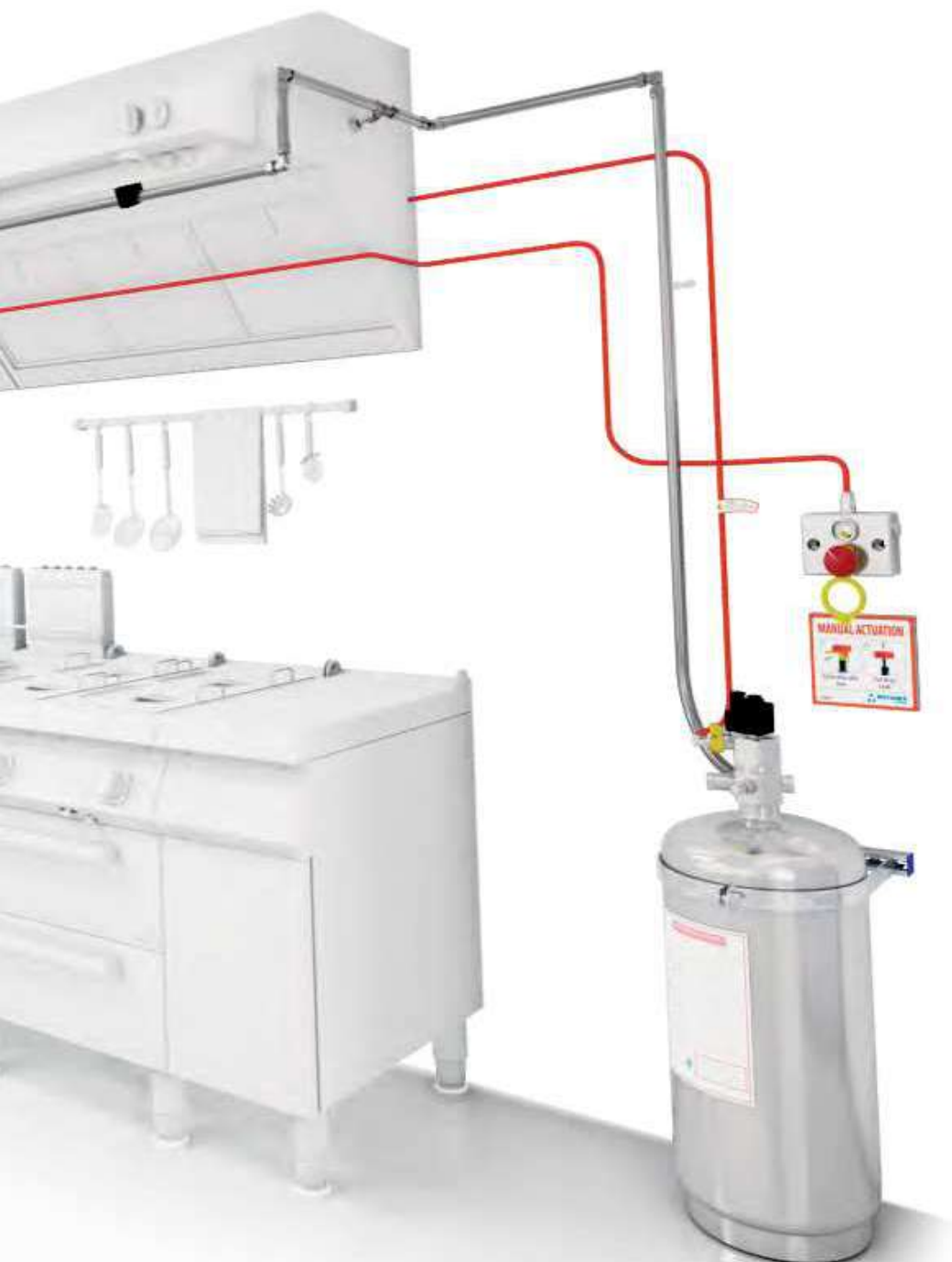
**IDEAL FOR THE PROTECTION OF:**

- Grill
- Deep fat fryer
- Extraction hood
- Duct
- Griddle
- Wok
- Electric char-broiler
- Range top
- Lava, pumice or synthetic rock char-broiler
- Natural charcoal broiler
- Chain broiler



LPCB Certified and Listed for Fixed Fire Extinguishing Systems for Catering Equipment. Tested for quality, Safety and Performance according to LPS 1223, Issue 2.3.

*Red tubing for visualization only.
System is installed with grey tubing

9L FIRE SUPPRESSION SYSTEM PRE-ENGINEERED FOR COMMERCIAL KITCHENS



- ★ Ideal for small- and medium-sized commercial kitchens
- ★ 9L TRIPLESTAR system can protect 3 zones
(Ex: 2 cooking areas + 1 hood)



*Red tubing for visualization only.
System is installed with grey tubing

EVERYTHING YOU NEED TOGETHER IN ONE BOX

KEY BENEFITS

- ★ Pre-engineered system: no preliminary calculation needed
- ★ Pre-defined components quantities to fit on most installations
- ★ Order one article and get everything you need in one box!



SYSTEM CONTENTS



COMMERCIAL KITCHEN SYSTEM

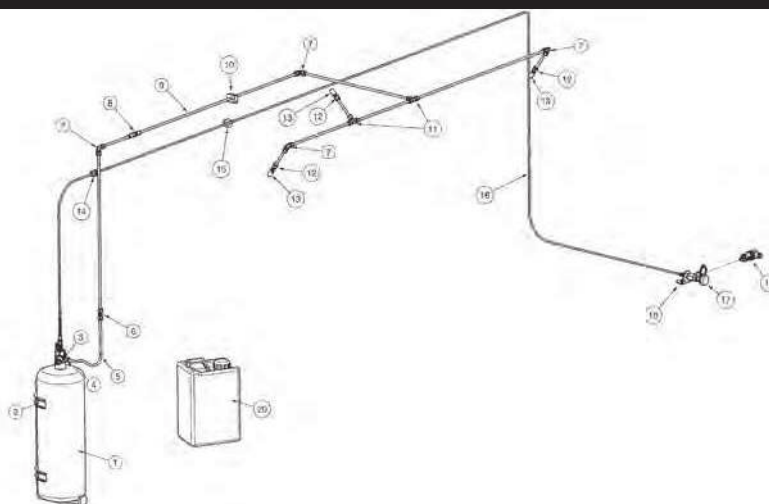

COMPLETE KITCHEN SYSTEM			
POS.	QTY.	CODE	DESCRIPTION
1	1	Varies	ILP cylinder/valve assembly (not filled)
2	1	024900401	Cylinder bracket
3	1	024100037	Steel joint
4	1	B07835039	Double ring fitting - straight R $\frac{1}{4}$ " - 8mm
5	1	022720040	Flexible stainless steel hose
6	1	B07835027	Double-ring fitting -straight 8mm
7	4	B07835028	Double ring fitting - elbow 8mm
8	1	B07835037	Double ring fitting - Cross-panel straight
9	6	022700599	8mm Stainless steel tubing (1 m)
10	10	B07860006	Pipe bracket 8mm
11	2	B07835029	Double ring fitting - tee - 8mm
12	3	B07835038	Double ring adapter - 8mm - R $\frac{1}{4}$ "
13	3	026200117	Nozzle
14	1	B07830005	Cross-panel fitting
15	20	B07860002	Screwed clips for sensor tube attachment
16	1	B07800303	FireDETEC® sensor tubing grey (10m)
17	1	varies	Manual actuator
18	1	024900414	Wall bracket (for LPCB system)
19	1	028255048	Pressure switch
20	1	020080157	9L canister of FireDETEC® F/K agent
21	1	028000279	Set of labels

PARTIAL KITCHEN SYSTEM (excluding discharge tubes and fittings)			
POS.	QTY.	CODE	DESCRIPTION
1	1	Varies	ILP cylinder/valve assembly (not filled)
2	1	024900401	Cylinder bracket
3	1	024100037	Steel joint
4	1	B07835039	Double ring fitting - straight R $\frac{1}{4}$ " - 8mm
5	1	022720040	Flexible stainless steel hose
13	3	026200117	Nozzle
14	1	B07830005	Cross-panel fitting
15	20	B07860002	Screwed clips for sensor tube attachment
16	1	B07800303	FireDETEC® sensor tubing grey (10m)
17	1	varies	Manual actuator
18	1	024900414	Wall bracket (for LPCB system)
19	1	028255048	Pressure switch
20	1	020080157	9L canister of FireDETEC® F/K agent
21	1	028000279	Set of labels

SPECIFICATIONS

WITH MANUAL ACTUATOR	
Complete kitchen system	Partial kitchen system (excluding discharge tubes and fittings)



WITH PISTON BLOCK ACTUATOR	
Complete kitchen system	Partial kitchen system (excluding discharge tubes and fittings)



Product code unfilled	B07503000	B07503001
Agent capacity	9 Liters	9 Liters
Number of nozzles	3	3
Cylinder volume	12,5 L	12,5 L
System approval	LPCB	LPCB
Cylinder approval	CE (PED)	CE (PED)
Operating Temperature	5°C to 50°C	5°C to 50°C
Working pressure	16 bar at 20°C	16 bar at 20°C
Sensor tubing color	Grey	Grey
Sensor tube connection	Standard	Standard
Valve with safety device	No	No

B07503002	B07503003
9 Liters	9 Liters
3	3
12,5 L	12,5 L
-	-
CE (PED)	CE (PED)
5°C to 50°C	5°C to 50°C
16 bar at 20°C	16 bar at 20°C
Grey	Grey
Quick-fit	Quick-fit
Yes	Yes

16L & 25L FIRE SUPPRESSION SYSTEM ENGINEERED FOR LARGE COMMERCIAL KITCHENS

- ★ Ideal for large commercial kitchens
- ★ Up to 9 cooking zones protected
- ★ 16L TRIPLESTAR system can protect 4-6 zones
(ex: up to 5 cooking areas + 1 hood)
- ★ 25L TRIPLESTAR system can protect 7-9 zones
(ex: up to 8 cooking areas + 1 hood)

KEY BENEFITS

- ★ Build your own bill of material
and cherry-pick you components
- ★ Choice between pneumatic
and/or electromagnetic actuation
- ★ Much faster installations
- ★ Much faster calculation
than conventional technologies



2 CORE KITS AVAILABLE
WITH 16L OR 25L CYLINDER



COMPLETE YOUR SYSTEM BY ORDERING THE FOLLOWING
COMPONENTS SEPARATELY ACCORDING TO YOUR NEEDS



(see p.53)

(see p.46)

(see p.54)

(see p.53)

(see p.52)

(see p.51)

KITCHEN CORE ASSEMBLIES

B07503005

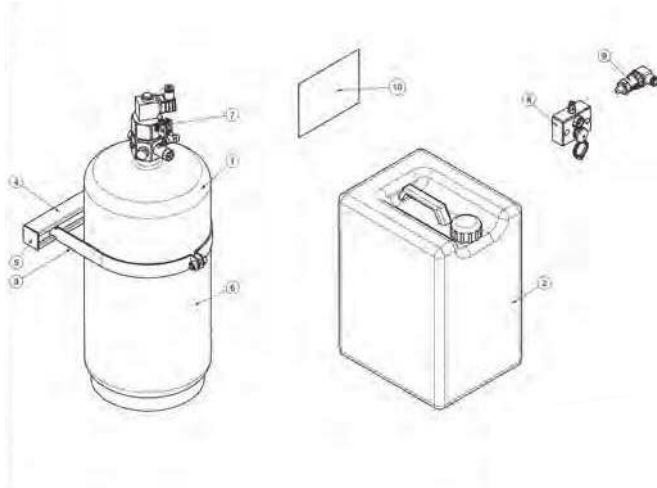

B07503006

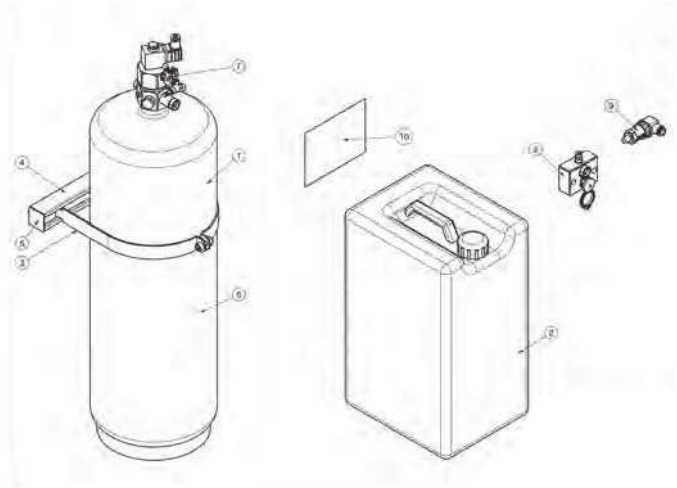

POS.	ART. NR	QTY	DESCRIPTION
1	B07013004	1	ILP assembly 16 liter (not filled)
2	020080164	1	Agent (16 liter canister)
3	024900451	1	Cylinder bracket
4	024900338	1	Wall mounting rail
5	024900322	2	End cap for mounting rail
6	028000091	1	Cylinder label
7	027200007	1	Tamper-evident seal
8	B04420150	1	Manual release device
9	028255048	1	Pressure switch
10	028000279	1	Set of labels

POS.	ART. NR	QTY	DESCRIPTION
1	B07013005	1	ILP assembly 25 liter (not filled)
2	020080156	1	Agent (25 liter canister)
3	024900451	1	Cylinder bracket
4	024900338	1	Wall mounting rail
5	024900322	2	End cap for mounting rail
6	028000091	1	Cylinder label
7	027200007	1	Tamper-evident seal
8	B04420150	1	Manual release device
9	028255048	1	Pressure switch
10	028000279	1	Set of labels

SPECIFICATIONS

WITH PISTON BLOCK ACTUATOR

16L core assembly



25L core assembly



Product code unfilled	B07503005	B07503006
Agent capacity	16 Liters	25 Liters
Cylinder volume	23 L	35 L
Cylinder approval	CE (PED)	CE (PED)
Operating Temperature	5°C to 50°C	5°C to 50°C
Working pressure	16 bar at 20°C	16 bar at 20°C
Sensor tubing color	Grey	Grey
Sensor tube connection	Quick-fit	Quick-fit
Valve with safety device	Yes	Yes

COMPACT LINE

A COMPLETE PRE-ENGINEERED SYSTEM FOR VEHICLE ENGINE COMPARTMENTS FOR ALL TYPES OF ON-ROAD AND OFF-ROAD VEHICLES

IDEAL FOR ALL VEHICLE ENGINE APPLICATIONS



MINIMIZES RISK TO VITAL EQUIPMENT

- Most vehicle fires start in the engine compartment
- Helps prevent passenger injury
- Helps minimize damage to vital equipment and surrounding areas
- Minimizes service downtime during repairs

KEY FEATURES

- Most compact system in the world¹
- Able to protect up to 4m³ engine compartment with only 4 liters of agent¹
- A complete, ready-to-install system - all in one box
- Available with liquid-based FireDETEC® TS-55 extinguishing agent
- Special patented cylinder designed specifically for high-vibration engine environments
- Available in 4L, 7L and 12L cylinder sizes
- Also available as a partial system without discharge tubes and fittings
- Cylinders available either empty or filled/pressurized

¹ According to UNECE R107 certification

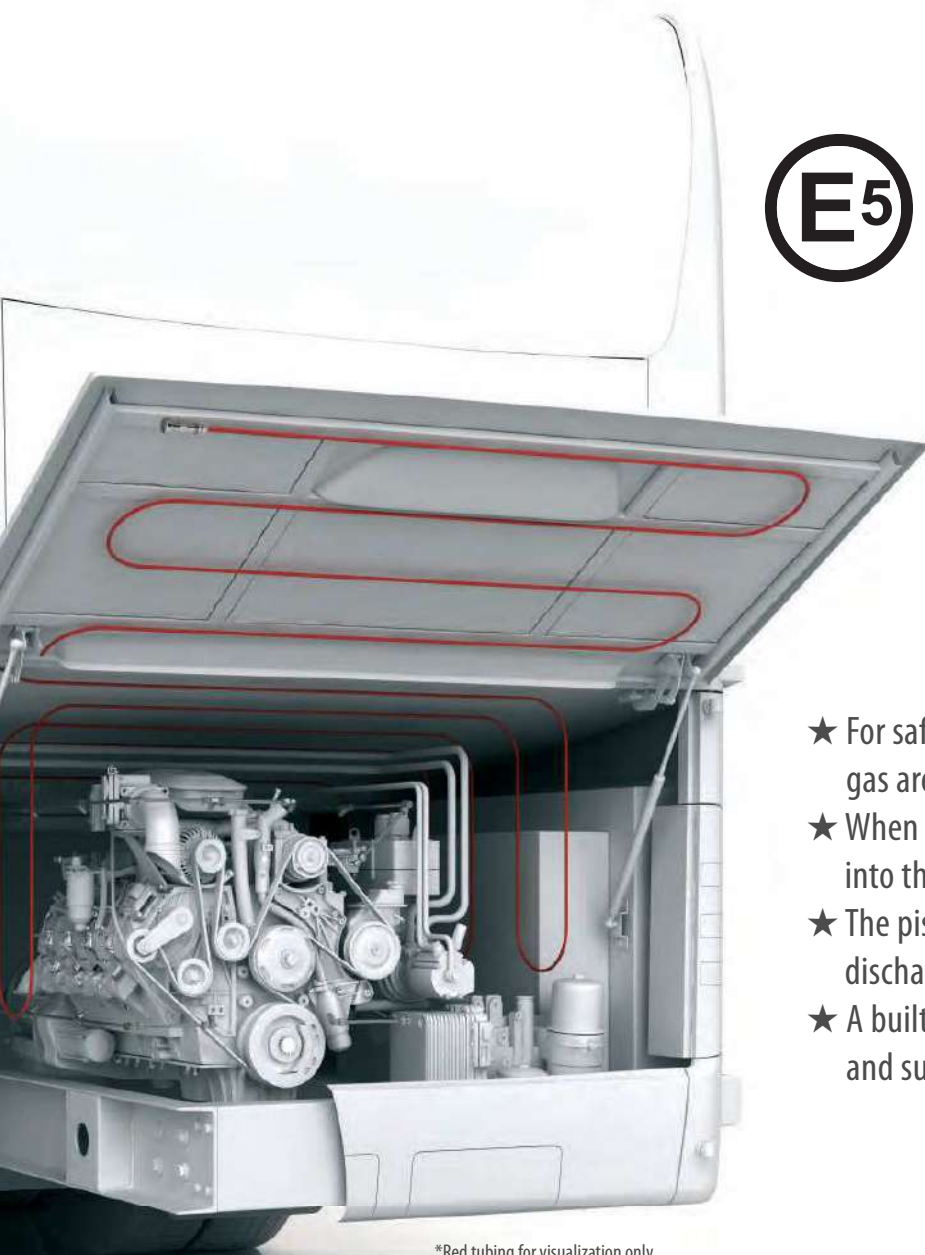

*Red tubing for visualization only.
System is installed with black tubing



COMPACT LINE® vehicle engine systems were the first systems to be SP-Certified according to SPCR 183 / SP method 4912, chapter 3



- ★ For safety, extinguishing liquid and pressurized gas are in separate chambers
- ★ When activated, the pressurized gas is released into the outer chamber forcing against a piston.
- ★ The piston pushes the liquid out through the discharge tube
- ★ A built-in pressure regulator ensures a constant and sustained discharge

Optional dashboard control unit available (see p.57)



Everything you need together in one box



SYSTEM CONTENTS

COMPLETE BUS ENGINE SYSTEM

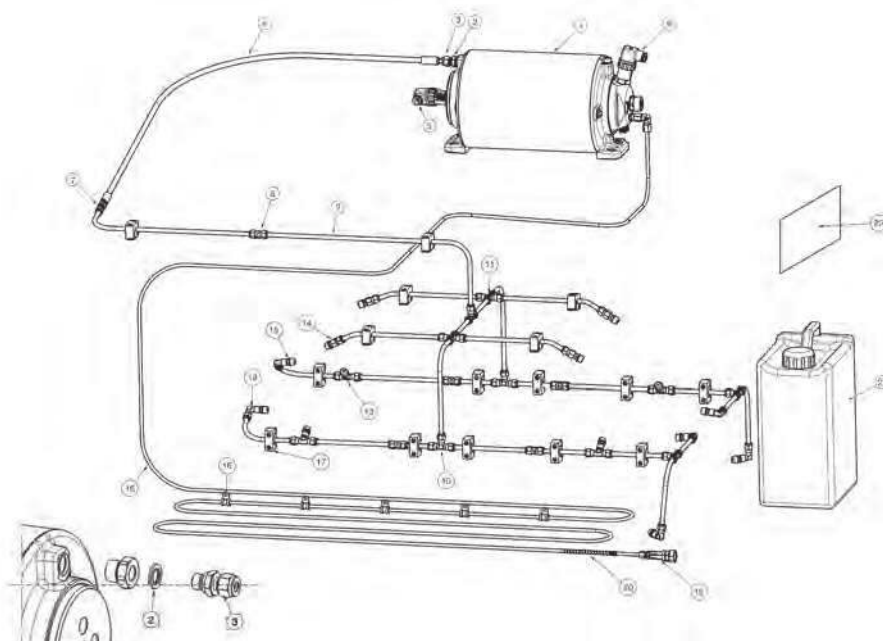

POS.	QTY.	CODE	DESCRIPTION
1	1	varies	Special dual chamber cylinder + fittings
2	1	024100037	Bonded seal
3	1	B07835026	Double ring fitting - straight G $\frac{1}{4}$ " - 8mm
4	1	022720039	Flexible stainless steel hose
5	1	028255048	Pressure switch (5 bar)
6	1	028255047	Pressure switch (160 bar)
7	1	B07835027	Fitting straight
8	9	026300339	Bicone fitting - straight - 8mm
9	12	022700641	8mm brass tubing (1m)
10	6	026600004	Bicone fitting - tee - 8mm
11	2	026610001	Bicone fitting - cross - 8mm
12	6	026500010	Bicone fitting - elbow - 8mm - G $\frac{1}{8}$ "
13	4	026600005	Bicone fitting - tee - 8mm - G $\frac{1}{8}$ "
14	4	026300340	Bicone fitting - straight - 8mm - G $\frac{1}{8}$ "
15	14	026205098	Nozzle
16	1	B07800202	FireDETEC sensor tubing black (10m)
17	20	B07860006	Screwed clips for discharge line
18	20	B07860011	Screwed clips for detection line
19	1	B07810025	End-of-line gauge - high vibration
20	1	B07850030	Protection spring for sensor tubing
21	1	varies	Agent canister TS-55
22	1	028000279	Set of labels

SPECIFICATIONS

Product code unfilled	B09027000	B09028000
Product code filled*	B09027500	B09028500
Agent capacity	4 Liters	7 Liters
Number of nozzles	14	14
Cylinder volume	4,0 L	7,0L
Cylinder approval	π	π
Operating Temperature	-30°C to 80°C	-30°C to 80°C
Working pressure	200 bar	200 bar
Sensor tubing color	Black	Black
Certification	Unece R107	Unece R107

*filled and pressurized

SYSTEM CONTENTS

COMPLETE OFF-ROAD VEHICLE ENGINE SYSTEM



eurofins
FA 127

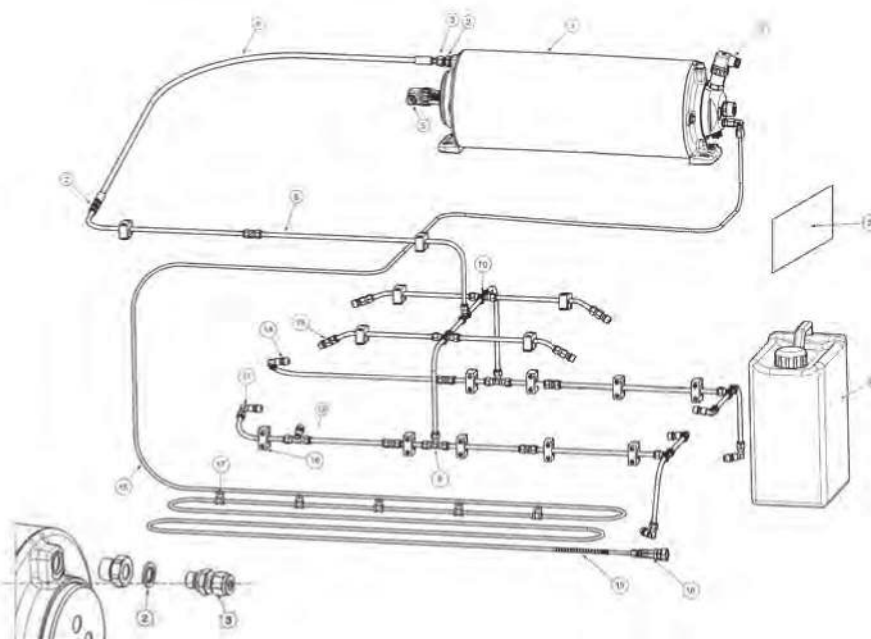

POS.	QTY.	CODE	DESCRIPTION
1	1	varies	Special dual chamber cylinder + fittings
2	1	024100037	Bonded seal
3	1	B07835026	Double ring fitting - straight G¼" - 8mm
4	1	022720039	Flexible stainless steel hose
5	1	028255048	Pressure switch (5 bar)
6	1	028255047	Pressure switch (160 bar)
7	varies	B07835027	Fitting straight
8	varies	022700599	8mm Stainless steel tubing (1m)
9	varies	B07835029	Double-ring fitting -tee - 8mm
10	varies	B07835033	Double-ring fitting -cross - 8mm
11	2	B07835031	Double-ring fitting -elbow - 8mm - R½" female
12	varies	B07835030	Double-ring fitting -tee - 8mm - R½" female
13	varies	B07835047	Double-ring fitting -straight - 8mm - R½" female
14	varies	026205098	Nozzle
15	1	B07800202	FireDETEC sensor tubing black (10m)
16	varies	B07860006	Screwed clips for discharge line
17	varies	B07860011	Screwed clips for detection line
18	1	B07810025	End-of-line gauge - high vibration
19	1	B07850030	Protection spring for sensor tubing
20	1	varies	Agent canister TS-55
21	1	028000279	Set of labels

SPECIFICATIONS

Product code unfilled	B09028002	B09029002
Product code filled*	B09028502	B09029502
Agent capacity	7 Liters	12 Liters
Number of nozzles	6	11
Cylinder volume	7,0 L	12,0L
Cylinder approval	π	π
Operating Temperature	-30°C to 80°C	-30°C to 80°C
Working pressure	200 bar	200 bar
Sensor tubing color	Black	Black
Standard	FA127	FA127

*filled and pressurized

ELECTRICAL CABINET - SMOKE DETECTION & SOLENOID ACTUATION



A system for electrical cabinets and other enclosed areas with electric circuitry that you configure yourself using available components.



Uses a special
B0439 solenoid
valve technology

MINIMIZES RISK TO VITAL EQUIPMENT

- Detects a fire before it even becomes a fire
- Ideal for early electrical fires that usually emit smoke before they become a flame
- Helps prevent the actual fire and sends a warning signal for intervention
- Less equipment damage. Much faster repair to put the electrical circuitry back in service.
- Prevents extensive cleanup if the sprinkler system discharges

KEY FEATURES

- All-electronic smoke detection instead of thermal pneumatic tube detection
- For CO₂ extinguishing agent
- Standardly delivered unfilled. Can be filled on request



RECOMMENDED SYSTEM CONFIGURATION

WHAT YOU SHOULD ORDER



	CYLINDER/VALVE ASSEMBLIES SOLENOID ACTUATION - 12 VDC - CO ₂			
Product code unfilled	B04394012	B04394006	B04394014	B04394015
Product code filled	On request	On request	On request	On request
Agent capacity	2 Kg.	5 Kg.	10 Kg. Short Ø204mm	20 Kg.
Cylinder volume	2.7 liters	6.7 liters	13.4 liters	27 liters
Cylinder approval	CE	CE	CE	CE
Cyl. / valve weight (empty)	6,8 Kg.	10 Kg.	21 Kg.	31 Kg.
Height	626 mm	737 mm	737 mm	1184 mm
Diameter	Ø 108 mm	Ø 140 mm	Ø 204 mm	Ø 204 mm
Siphon tube	Yes	Yes	Yes	Yes
Operating temperature	-20°C to 60°C	-20°C to 60°C	-20°C to 60°C	-20°C to 60°C
Voltage	12V	12V	12V	12V



CAUTION! B0439 CYLINDER / VALVE ASSEMBLIES WITH 12V COIL

CONFIGURE CYLINDER/VALVE ASSEMBLIES TO YOUR
NEEDS BY ORDERING COMPONENTS SEPARATELY

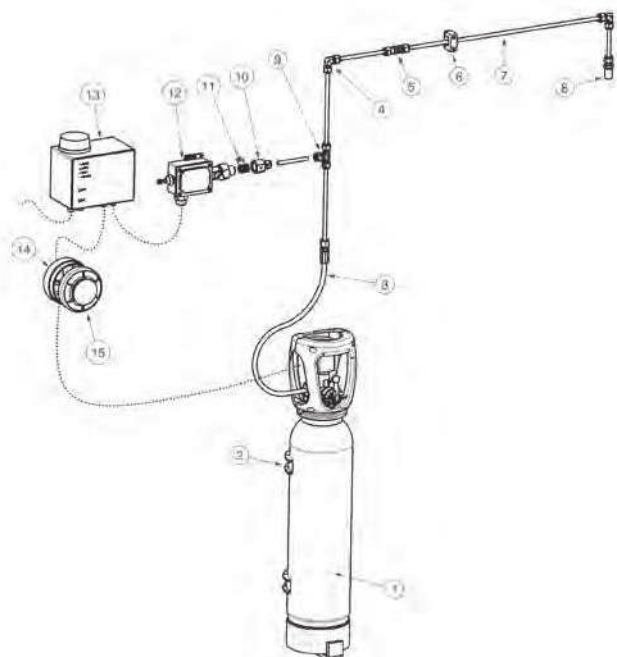

POS.	QTY.	CODE	DESCRIPTION	
1	1	varies	Cylinder acc. to your need	See above
2	1	varies	Cylinder bracket acc. to your need	pg. 57
3	1	B06920006	Flexible piping	pg. 53
4	1	B07835037	Tube fitting - Cross panel	pg. 51
5	2	B07835028	Tube fitting - Elbow	pg. 51
6	4	B07860006	Pipe bracket Ø8 mm	pg. 53
7	3	022700599	Stainless steel pipe Ø8 mm (1m)	pg. 51
8	1	026200116	Nozzle	pg. 54
9	1	B07835029	Tube fitting - Tee Ø8	pg. 51
10	1	B07835045	Adaptor 8 mm - G ½"	pg. 56
11	3	024100013	Fiber joint	pg. 65
12	1	028250050	Pressure switch	pg. 56
13	1	B07850201	Control Box	pg. 55
14	1	028260001	Fume detector relay base	pg. 47
15	1	028220102	Fume detector	pg. 47

ABC DRY CHEMICAL SYSTEM



- A semi-complete fire suppression system using ABC dry chemical extinguishing agent - excluding the discharge tubes and fittings
- An economic alternative to chemical or CO₂ systems

IDEAL FOR:

- Flammable chemicals
- Storage areas
- Partially open areas
- Waste storage
- Chemical storage

KEY FEATURES

- Indirect system only
- Available in 3 cylinder sizes for small, medium and large installations
- Each cylinder available with multiple nozzle quantities
- Discharge line is not included
- Cylinders available filled / pressurized

Empty cylinders on request



SYSTEM CONFIGURATIONS

POWDER SYSTEMS - 1 NOZZLE

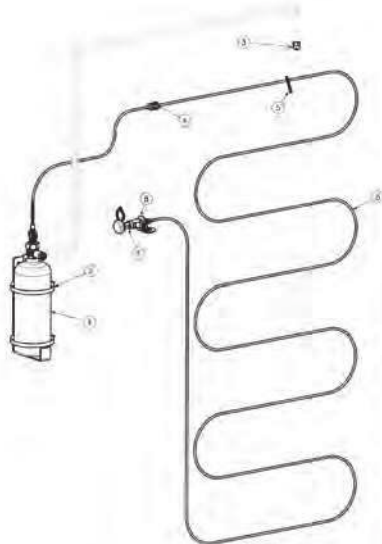

POS.	QTY.	DESCRIPTION
1	1	ILP cylinder/valve assembly (not filled) + label
2	1	Cylinder bracket
3	1	Nozzle G¼" (13 x Ø1,5mm)
4	1	Cross-panel fitting
5	20	Binding ties
6	1	FireDETEC® sensor tubing black (10m)
7	1	Manual release device
8	1	Wall bracket for manual release

POWDER SYSTEMS - 2 NOZZLE

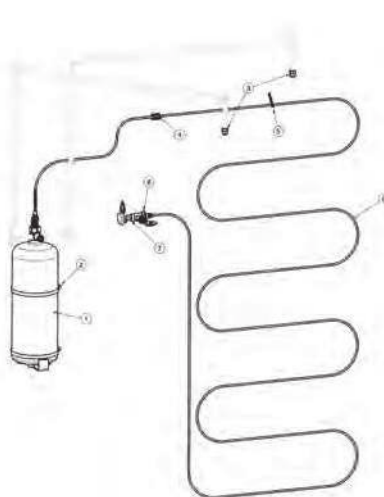

POS.	QTY.	DESCRIPTION
1	1	ILP cylinder/valve assembly (not filled) + label
2	1	Cylinder bracket
3	2	Nozzle G¼" (13 x Ø1,5mm)
4	1	Cross-panel fitting
5	20	Binding ties
6	1	FireDETEC® sensor tubing black (10m)
7	1	Manual release device
8	1	Wall bracket for manual release

POWDER SYSTEMS - 4 NOZZLE

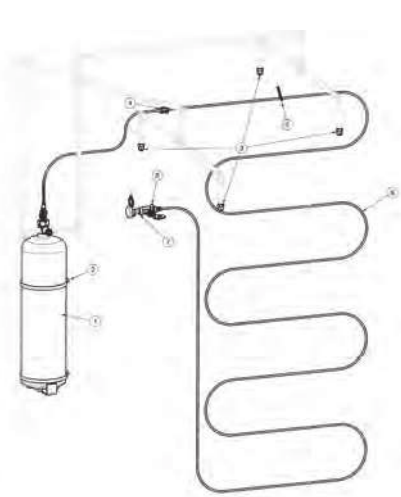

POS.	QTY.	DESCRIPTION
1	1	ILP cylinder/valve assembly (not filled) + label
2	1	Cylinder bracket
3	4	Nozzle G¼" (13 x Ø1,5mm)
4	1	Cross-panel fitting
5	20	Binding ties
6	1	FireDETEC® sensor tubing black (10m)
7	1	Manual release device
8	1	Wall bracket for manual release

	2 KG	6 KG	9 KG
Product code unfilled	On request	On request	On request
Product code filled*	B07508000	B07508003	B07508005
Agent capacity	2 Kg.	6 Kg.	9 Kg.
Number of nozzles included in the system	1	2	2
Minimum ordering quantity	6	4	2
Nozzle configuration possible	1, 2 or 4 nozzles	2 or 4 nozzles	2 or 4 nozzles
Cylinder volume	2,5 L	7,5 L	11,25 L
Cylinder approval	CE	CE	CE
Operating Temperature	-20°C to 60°C	-20°C to 60°C	-20°C to 60°C
Working pressure	15 bar	15 bar	15 bar
Siphon tube	Yes	Yes	Yes
Sensor tubing color	Black	Black	Black

*filled and pressurized

CYLINDER / VALVE ASSEMBLIES PNEUMATIC ACTUATION | CO₂

Cylinder/Valve assemblies that you configure yourself by choosing individual components/accessories.

Select the sensor tube system, discharge line, nozzles and accessories that fit your exact installation.

ALL KITS INCLUDE:

- Cylinder
- Valve
- Ball valve
- Siphon Tube

KEY FEATURES

- Maximum flexibility by configuring the system yourself
- Filled or unfilled with CO₂.



Label not included (see p. 61)



	CO ₂ SYSTEM - INDIRECT						CO ₂ SYSTEM - DIRECT	
Product code unfilled	B07024000	B07024001	B07024002	B07024008	B07024012	B07024013	B07034000	B07034001
Product code filled	B07024500	B07024501	B07024502	B07024508	B07024512	B07024513	B07034500	B07034501
Agent capacity	2 Kg.	5 Kg.	10 Kg. Short Ø204mm	10 Kg. Tall Ø140mm	20 Kg.	30 Kg.	2 Kg.	5 Kg.
Cylinder volume	2.7 liters	6.7 liters	13.4 liters	13.4 liters	26.7 liters	40.0 liters	2.7 liters	6.7 liters
Cylinder approval	π	π	π	π	π	π	π	π
Cyl. / valve weight (empty)	6,8 Kg.	10 Kg.	21 Kg.	18,5 Kg.	32 Kg.	41,5 Kg.	5,9 Kg.	9,1 Kg.
Height	626 mm	737 mm	737 mm	1207 mm	1183 mm	1681 mm	626 mm	737 mm
Diameter	Ø 108 mm	Ø 140 mm	Ø 204 mm	Ø 140 mm	Ø 204 mm	Ø 204 mm	Ø 108 mm	Ø 140 mm
Siphon tube	Yes	Yes	Yes	Yes	Yes	Yes	Yes	Yes
Operating temperature	-20°C to 60°C	-20°C to 60°C	-20°C to 60°C	-20°C to 60°C	-20°C to 60°C	-20°C to 60°C	-20°C to 60°C	-20°C to 60°C

	CO ₂ SYSTEM WITH DIMES - INDIRECT					
Product code unfilled	B07025000	B07025001	B07025006	B07025002	B07025003	B07025004
Product code filled	B07025500	B07025501	B07025506	B07025502	B07025503	B07025504
Agent capacity	2 Kg.	5 Kg.	10 Kg. Short Ø204mm	10 Kg. Tall Ø140mm	20 Kg.	30 Kg.
Cylinder volume	2.7 liters	6.7 liters	13.4 liters	13.4 liters	26.7 liters	40.0 liters
Cylinder approval	π	π	π	π	π	π
Cyl. / valve weight (empty)	7,4 Kg.	10,6 Kg.	21,6 Kg.	19,1 Kg.	32,6 Kg.	42,1 Kg.
Height	626 mm	737 mm	737 mm	1207 mm	1183 mm	1681 mm
Diameter	Ø 108 mm	Ø 140 mm	Ø 204 mm	Ø 140 mm	Ø 204 mm	Ø 204 mm
Siphon tube	Yes	Yes	Yes	Yes	Yes	Yes
Operating temperature	-20°C to 60°C	-20°C to 60°C	-20°C to 60°C	-20°C to 60°C	-20°C to 60°C	-20°C to 60°C



CYLINDER / VALVE ASSEMBLIES SOLENOID ACTUATION | CO₂

Cylinder/Valve assemblies that you configure yourself by choosing individual components/accessories.

For fire suppression systems using electronic detection devices, such as smoke detectors, thermal bulbs, etc.

Not for use with pneumatic detection tubing.

ALL KITS INCLUDE:

- Cylinder
- Valve
- Ball valve
- Siphon Tube
- Labels are not included

KEY FEATURES

- Available with wide choice of cylinder sizes, filled or unfilled with CO₂.



CAUTION: 24V cylinder valve assembly



	CO ₂ SYSTEM - SOLENOID ACTUATION					
Product code unfilled	B04394001	B04394000	B04394002	B04394003	B04394007	B04394008
Product code filled	B04394501	B04394500	B04394502	On request	On request	On request
Agent capacity	2 Kg.	5 Kg.	10 Kg. Short Ø204mm	10 Kg. Tall Ø140mm	20 Kg.	30 Kg.
Cylinder volume	2.7 liters	6.7 liters	13.4 liters	13.4 liters	26,7 liters	40.0 liters
Cylinder approval	CE	CE	CE	CE	CE	CE
Cyl. / valve weight (empty)	6,8 Kg.	10 Kg.	21 Kg.	18,5 Kg.	32 Kg.	41,5 Kg.
Height	626 mm	737 mm	737 mm	1207 mm	1183 mm	1681 mm
Diameter	Ø 108 mm	Ø 140 mm	Ø 204 mm	Ø 140 mm	Ø 204 mm	Ø 204 mm
Siphon tube	Yes	Yes	Yes	Yes	Yes	Yes
Operating temperature	-20°C to 60°C	-20°C to 60°C	-20°C to 60°C	-20°C to 60°C	-20°C to 60°C	-20°C to 60°C
Voltage	24V	24V	24V	24V	24V	24V



	CO ₂ SYSTEM WITH DIMES - SOLENOID ACTUATION			
Product code unfilled	B04395005	B04395004	B04395000	B04395001
Product code filled	On request	B04395504	B04395500	B04395501
Agent capacity	2 Kg.	5 Kg.	10 Kg. Short Ø204mm	30 Kg.
Cylinder volume	2.7 liters	6.7 liters	13.4 liters	40.0 liters
Cylinder approval	CE	CE	CE	CE
Cyl. / valve weight (empty)	7,4 Kg.	10,6 Kg.	21,6 Kg.	42,1 Kg.
Height	626 mm	737 mm	737 mm	1681 mm
Diameter	Ø 108 mm	Ø 140 mm	Ø 204 mm	Ø 204 mm
Siphon tube	Yes	Yes	Yes	Yes
Operating temperature	-20°C to 60°C	-20°C to 60°C	-20°C to 60°C	-20°C to 60°C
Voltage	24V	24V	24V	24V



CYLINDER/VALVE ASSEMBLIES | WITH NOVEC 1230 FLUID

Cylinder/Valve assemblies that you configure yourself by choosing individual components/accessories.

Select the sensor tube system, discharge line, nozzles and accessories that fit your exact installation.



*Applies only to CE/DOT Indirect systems ordered and filled IN THE USA BY:
ROTAREX NORTH AMERICA 101 Bilby Road,
Building #2 Hackettstown, NJ07840

ALL KITS INCLUDE:

- Cylinder
- Valve
- Ball valve
- Siphon Tube
- Mounting Brackets

KEY FEATURES

- Cylinders are filled and charged with Novec1230 Fluid (DOT cylinder only)
- Maximum flexibility by configuring the system yourself
- Available with wide choice of cylinder sizes

CE/DOT CYLINDERS



1.36 Kg. / 3 lbs



3.18 Kg. / 7 lbs



6.35 Kg. / 14 lbs

INDIRECT

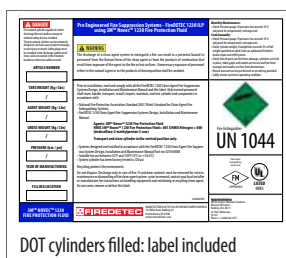

DOT cylinders filled: label included

NOVEC 1230 FLUID CE/DOT-approved cylinders (US & EU standards)

Product code unfilled	B07014003	B07014004	B07014005
Product code filled	B07014535	B07014536	B07014537
Product code filled UL/FM	B07014524	B07014525	B07014526
Agent capacity	3 lbs.	7 lbs.	14 lbs.
Cylinder volume	75 in ³	174 in ³	350 in ³
Cylinder approval	CE/DOT	CE/DOT	CE/DOT
Cyl. / valve weight (empty)	2,1 Kg. / 4,7 lbs	3,5 Kg. / 7,7 lbs	5,5 Kg. / 12,1 lbs
Height	384 mm	423 mm	546 mm
Diameter	Ø85 mm	Ø130 mm	Ø150 mm
Siphon tube	Yes	Yes	Yes
Operating temperature	0°C to 54°C	0°C to 54°C	0°C to 54°C

DOT CYLINDERS

CE CYLINDERS



1.36 Kg./3 lbs



3.18 Kg./7 lbs



1.36 Kg./3 lbs



3.18 Kg./7 lbs

DIRECT

NOVEC 1230 FLUID DOT-approved cylinders (North American standards)

Product code unfilled	B07004011	B07004012
Product code filled	B07004516	B07004517
Agent capacity	3 lbs.	7 lbs.
Cylinder volume	75 in ³	174 in ³
Cylinder approval	DOT	DOT
Cyl. / valve weight (empty)	2 Kg. / 4,6 lbs	2.8 Kg. / 6,2 lbs
Height	16"	15.27"
Diameter	Ø2.929"	Ø4.992"
Siphon tube	Yes	Yes
Operating temperature	0°C to 54°C	0°C to 54°C

NOVEC 1230 FLUID CE-approved cylinders (European standards)

B07004014	B07004015
1.36 kg	3.1 kg
75 in ³	174 in ³
CE	CE
2 Kg. / 4,6 lbs	2,8 Kg. / 6,2 lbs
352mm	403mm
Ø90mm	Ø125mm
Yes	Yes
0°C to 54°C	0°C to 54°C

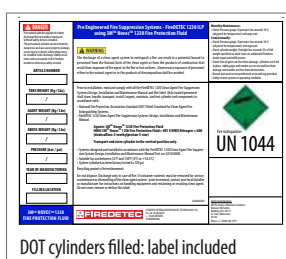

DOT cylinders filled: label included

CYLINDER / VALVE ASSEMBLIES | WITH FM200 / HFC-227 ea

Cylinder/Valve assemblies that you configure yourself by choosing individual components/accessories.

Select the sensor tube system, discharge line, nozzles and accessories that fit your exact installation.



*Applies only to CE/DOT Indirect systems ordered and filled IN THE USA BY: ROTAREX NORTH AMERICA 101 Bilby Road, Building #2 Hackettstown, NJ07840

ALL KITS INCLUDE:

- Cylinder
- Valve
- Ball valve
- Siphon Tube
- Mounting Brackets

KEY FEATURES

- Filled and charged with FM-200® (DOT cylinder only)
- Maximum flexibility by configuring the system yourself
- Available with wide choice of cylinder sizes and cylinder approvals

CE/DOT CYLINDERS



1.36 Kg. / 3 lbs

3.18 Kg. / 7 lbs

6.35 Kg. / 14 lbs

INDIRECT

FM-200® SYSTEMS CE/DOT approved cylinders (US & EU standards)

Product code unfilled	B07014000	B07014001	B07014002
Product code filled UL/FM	B07014500	B07014501	B07014502
Agent capacity	3 lbs.	7 lbs.	14 lbs.
Cylinder volume	75 in ³	174 in ³	350 in ³
Cylinder approval	CE/DOT	CE/DOT	CE/DOT
Cyl. / valve weight (empty)	2,1 Kg. / 4,7 lbs	3,5 Kg. / 7,7 lbs	5,5 Kg. / 12,1 lbs
Height	384 mm	423 mm	546 mm
Diameter	Ø85 mm	Ø130 mm	Ø150 mm
Siphon tube	Yes	Yes	Yes
Operating temperature	0°C to 54°C	0°C to 54°C	0°C to 54°C

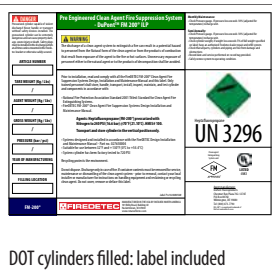

DOT CYLINDERS

CE CYLINDERS



1.36 Kg./3 lbs

3.18 Kg./7 lbs

1.36 Kg./3 lbs

3.18 Kg./7 lbs

DIRECT

FM-200® SYSTEMS - DOT-approved cylinders (North American standards)

Product code unfilled	B07004000	B07004001
Product code filled	B07004500	B07004501
Agent capacity	3 lbs.	7 lbs.
Cylinder volume	75 in ³	174 in ³
Cylinder approval	DOT	DOT
Cyl. / valve weight (empty)	2 Kg. / 4,6 lbs	2.8 Kg. / 6,2 lbs
Height	16"	15.27"
Diameter	Ø2.929"	Ø4.992"
Siphon tube	Yes	Yes
Operating temperature	0°C to 54°C	0°C to 54°C

FM-200® SYSTEMS - CE approved cylinders (European standards)

B07004004	B07004005
1.36 kg	3.18 kg
75 in ³	174 in ³
CE	CE
2 Kg. / 4,6 lbs	2,8 Kg. / 6,2 lbs
352mm	403mm
Ø90mm	Ø125mm
Yes	Yes
0°C to 54°C	0°C to 54°C



CYLINDER / VALVE ASSEMBLY | KITCHEN SYSTEM



- For commercial kitchen installations
- Cylinder & valve assemblies that you configure yourself by choosing individual components / accessories
- Choose the sensor tube system, discharge system and accessories that fit your exact installation

CYLINDER / VALVE ASSEMBLY:

- Cylinder (unfilled)
- Valve
- Siphon tube
- Labels included (not sticked)

3 CYLINDER SIZES

- 9, 16 or 25 liters
- Cylinders are delivered unfilled
- Cylinders can easily be filled and pressurized prior to installation
- FireDETEC® F/K extinguishing agent must be ordered separately (p.60)

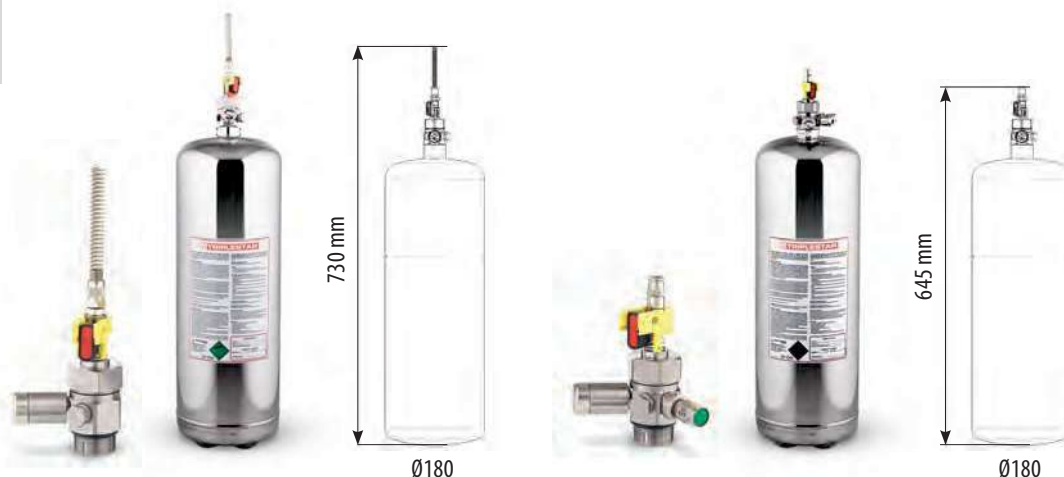

	Without safety device	With safety device
Product code unfilled	B07013000	B07013001
Agent capacity	9 liters	9 liters
Cylinder volume	12,5 liters	12,5 liters
Cylinder approval	CE (PED)	CE (PED)
Cyl. / valve weight (empty)	4,5 Kg.	4,5 Kg.
Cylinder material	Stainless Steel	Stainless Steel
Siphon tube	Yes	Yes
Sensor tube connection	Standard	Quick fitting
Valve safety device	No	Yes

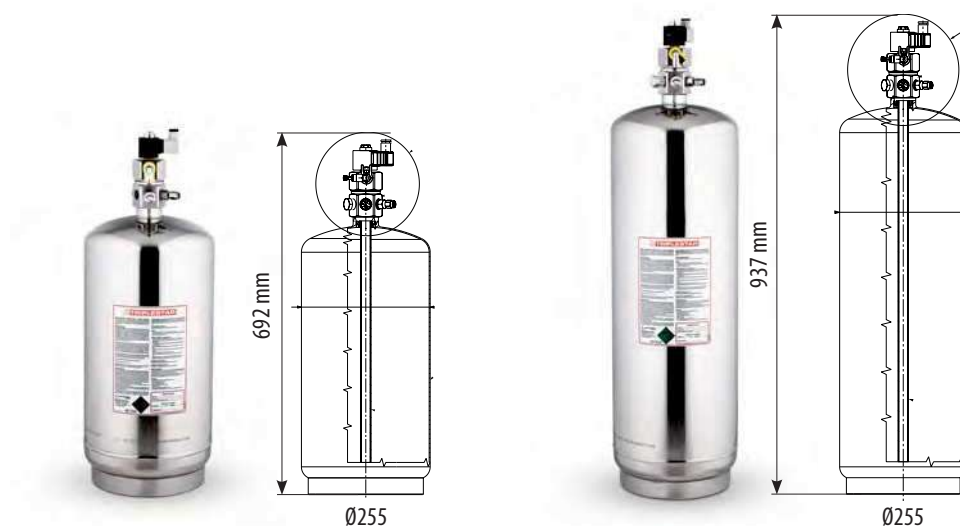

	B07013004	B07013005
Product code unfilled	B07013004	B07013005
Agent capacity	16 liters	25 liters
Cylinder volume	23 liters	35 liters
Cylinder approval	CE (PED)	CE (PED)
Cyl. / valve weight (empty)	11,6kg.	15,4kg
Cylinder material	Stainless Steel	Stainless Steel
Siphon tube	Yes	Yes
Sensor tube connection	Quick fitting	Quick fitting
Valve safety device	Yes	Yes

CYLINDER / VALVE ASSEMBLY | VEHICLE ENGINES **COMPACT LINE**

- For vehicle engine installations
- Cylinder & valve assemblies that you configure yourself by choosing individual components / accessories
- Choose the sensor tube system, discharge system and accessories that fit your exact installation

CYLINDER / VALVE ASSEMBLY:

- Integrated brackets
- Valve
- Label
- Choice between FireDETEC pneumatic actuation or electromagnetic actuation (EMA).

3 CYLINDER SIZES

4, 7 and 12 liters

Cylinders available either unfilled or filled/pressurized

If ordered unfilled, FireDETEC TS-55 must be ordered separately (p.60)

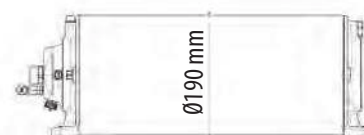

FDT	EMA
384,6 (4L)	445 mm (4L)
566 mm (7L)	604 mm (7L)
830 mm (12L)	830 mm (12L)

	FireDETEC	Electromagnetic	FireDETEC	Electromagnetic	FireDETEC	Electromagnetic
Product code unfilled	B09024000	B09024010	B09025000	B09025010	B09023000	B09023010
Product code filled	B09024500	B09024510	B09025500	B09025510	B09023500	B09023510
Cylinder volume	4 liters	4 liters	7 liters	7 liters	12 liters	12 liters
Cylinder approval	π	π	π	π	π	π
Cyl. weight (empty)	8,4 Kg. > 9,7 Kg.	8,4 Kg. > 9,7 Kg.	12,5 Kg. > 12,0 Kg.	12,5 Kg. > 12,0 Kg.	25 Kg. > 15,8 Kg.	25 Kg. > 15,8 Kg.
Siphon tube	No	No	No	No	No	No
Operating temperature range	-35°C to 80°C		-35°C to 80°C		-35°C to 80°C	

CYLINDER / VALVE ASSEMBLIES | ABC DRY CHEMICAL

- For Indirect ABC Dry Chemical systems
- Cylinder/Valve assembly for ABC dry chemical systems that you configure yourself using individual components / accessories

CYLINDER/VALVE ASSEMBLY:

- Cylinder
- ILP Valve
- Siphon tube
- Ball valve
- Mounting Bracket
- Labels must be ordered separately (p.62)

KEY FEATURES

- Maximum flexibility by configuring the system yourself
- Available with choice of 3 cylinder sizes: 2 Kg. / 6 Kg. / 9 Kg.



Product code unfilled	B07018000	B07018001	B07018002
Product code filled	B07018500	B07018501	B07018502
Cylinder kit size	2 Kg.	6 Kg.	9 Kg.
Cylinder volume	2,6 L	7.0 L	10,4 L
Cylinder approval	CE	CE	CE
Cyl. weight (empty)	2,5 Kg.	5,8 Kg.	7,1 Kg.
Operating Temperature	-20°C to 60°C	-20°C to 60°C	-20°C to 60°C
Working pressure	15 bar	15 bar	15 bar
Siphon tube	Yes	Yes	Yes
Minimum ordering quantity	6	4	2

FIREDETEC® SENSOR TUBING - 6 mm

6mm FireDETEC® sensor tubing in 10m or 100m lengths.

KEY FEATURES

- Choice of all-purpose or special application versions
- Available in 10 meter and 100 meter lengths
- See pages 8-9 for additional detail

ALL-PURPOSE SENSOR TUBING



SPECIAL APPLICATION SENSOR TUBING



SENSOR TUBING FOR KITCHEN SYSTEMS



	10 meters	100 meters	10 meters	100 meters	10 meters	100 meters
Product code	B07800015	B07800002	B07800202	B07800200	B07800303	B07800301
Application	For all applications		Multi-layer construction is more resistant to temperature extremes, chemical agents and UV		Specifically designed to withstand heat and grease conditions above kitchen cooking areas	
Ideal for	Electrical cabinets, relay boxes, CNC machines, construction machinery, agricultural machines		Laboratory fume hoods, chemical storage areas, petroleum storage tanks, hydraulic equipment, vehicle engines		Professional Kitchens Zones at risk for grease fire	
Outside Diameter	Ø: 0.234" / 6 mm		Ø: 0.234" / 6 mm		Ø: 0.234" / 6 mm	
Inside Diameter	Ø: 0.156" / 4 mm		Ø: 0.156" / 4 mm		Ø: 0.156" / 4 mm	
Color	Red RAL 3000		Black RAL 9005		Grey RAL 1018	
Min. bend radius	4" / 100 mm		5.9" / 150 mm		5.9" / 150 mm	
Burst temperature	110°C		110°C		175°C	
Operating t° range	-30°C to 80°C		-30°C to 80°C		-30°C to 90°C	

FIREDETEC® SENSOR TUBING - 8 mm

8mm FireDETEC® sensor tubing for Direct systems using clean agent extinguishing agent.

8 mm TUBING



8 mm ADAPTER



	100 meters	Converts a 6 mm device to 8mm
Product code	B07800022	B07831011
Outside Diameter	8 mm	for 8 mm tubing
Color	Red RAL 3000	Nickel plated brass
Burst temperature	110°C	-
Temperature range	-30°C to 80°C	-30°C to 80°C

PRESSURE SWITCH MANIFOLD

Used to add supplemental functionalities (pressure switch, solenoid actuator)



Product code	B07850046
Number of entry	5 (4xM10+1xG1/4")
Pressure gauge	Included (0-20 bar)
Working pressure	20 bar
Length	232 mm
Height	40 mm
Width	30 mm

KEY FEATURES

- Ideal to send several signals on advanced installations
- Aluminium monobody design
- Integrated pressure gauge

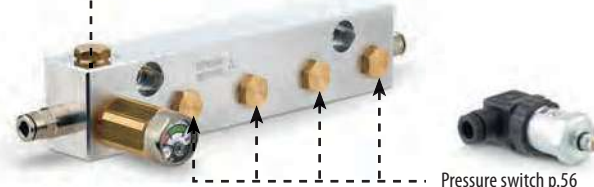

PROTECTION SPRING

To protect the sensor tubing from damage for Ø 6 mm tubing



For standard end connections



For quick connect connections



Product code

B07850030

022200040

KEY FEATURES

- Coils around the entire length of the sensor tube to provide a protective casing
- Choice of standard or quick connect fittings

Length

33' / 10 meters

Material

Stainless Steel

PROTECTION SPRING TOP

To protect the sensor tubing connection when using standard fittings for Ø 6 mm tubing.



Product code

024920013

KEY FEATURES

- Helps maintain a safe and tight sensor tubing connection
- With standard connection

SENSOR TUBE ATTACHMENTS

Secures sensor tubing securely in place.

SELF-ADHESIVE CLIP*

for Ø 6 mm



SELF-ADHESIVE BINDING TIE*



BINDING TIE*



SCREWED CLIP



Product code	B07860000	B07860005	B07860004	B07860002	B07860011
Material	Polyamide	Polyamide	Polyamide	Aluminium and chloroprene	
Attachment	Self-adhesive base	Self-adhesive base		screws (not included)	

*Not for use in engine compartment

SMOKE DETECTOR

To detect a fire in its earliest stages by detecting the smoke it emits before flames appear

Can be used as a detector for the B0439 Smoke Detector System, or as an incremental detection device for systems with FireDETEC® sensor-tube detection.

KEY FEATURES

- CE-approved
- Audio and LED visual signal

SENSOR UNIT



RELAY BASE



Product code	028220102	028260001
Height	32,5 mm	33 mm
Diameter	102 mm	102,5 mm
Material	ABS	ABS
Power Supply	8-30VDC	10-15 VDC
Maximum alarm current	80mA	
IP rating	IP 40	IP 40
Operating temperature	-30°C to 70°C	-30°C to 70°C

All installation wiring must conform to applicable local and national codes

QUICK CONNECTION FITTINGS FOR SENSOR TUBING Ø 6 mm

Fittings to connect
FireDETEC® sensor tubing.

KEY FEATURES

- Plug-in connections for quick, secure and leak-free installations
- Nickel plated brass

STRAIGHT COUPLING



ELBOW



TEE



STRAIGHT END



END ELBOW



END TEE



Product code	B07831010	B07831006	B07831007	B07831005	B07831008	B07831003
Connections	0.234" / Ø 6 mm	0.234" / Ø 6 mm	0.234" / Ø 6 mm	0.234" / Ø 6 mm G $\frac{1}{8}$ " male	0.234" / Ø 6 mm G $\frac{1}{8}$ " male	0.234" / Ø 6 mm G $\frac{1}{8}$ " male
Material	Nickel - Plated brass	Nickel - Plated brass	Nickel - Plated brass	Nickel - Plated brass	Nickel - Plated brass	Nickel - Plated brass

STANDARD CONNECTION FITTINGS FOR SENSOR TUBING Ø 6 mm

Fittings to connect
FireDETEC® sensor tubing.

KEY FEATURES

- Forms secure, leak-tight connections of sensor tubing
- Available in multiple configurations
- Material: nickel plated brass

END FITTING



STRAIGHT FITTING



STRAIGHT PANEL FITTING



TEE FITTING



CROSS FITTING



Gasket 024100034
Must be ordered separately p.58

Product code	B07830010	B07830002	B07830004	B07830000	B07830001
Connections	0.234" / Ø 6 mm G $\frac{1}{8}$ " male	0.234" / Ø 6 mm	0.234" / Ø 6 mm	0.234" / Ø 6 mm	0.234" / Ø 6 mm
Material	Nickel - Plated brass	Nickel - Plated brass	Nickel - Plated brass	Nickel - Plated brass	Nickel - Plated brass

G THREADS ARE PARALLEL THREADS ACCORDING TO ISO 228/1

HIGH VIBRATION FITTINGS FOR SENSOR TUBING Ø 6 mm

Fittings to connect FireDETEC® sensor tubing in high-vibration environments.

KEY FEATURES

- Double ferrule fittings for exceptional grip in high vibration environments
- Must be used with tube support B07830023 (not included)



Tube support B07830023 must be ordered separately



Gasket 024100034
Must be ordered
separately p.58

Gasket 024100034
Must be ordered
separately p.58

For all non-turning fittings
B07830032
For all turning fittings
B07830025

Product code	B07830024	B07830029	B07830021	B07830025	B07830022	B07830023	B07830033
Connections	0.234" / Ø 6 mm G $\frac{1}{8}$ " male	0.234" / Ø 6 mm	0.234" / Ø 6 mm	0.234" / Ø 6 mm G $\frac{1}{8}$ " male	0.234" / Ø 6 mm	0.234" / Ø 6 mm	0.234" / Ø 6 mm
Material	Galvanized Steel	Galvanized Steel	Galvanized Steel	Galvanized Steel	Galvanized Steel	Brass	Galvanized Steel / Polyamide

G THREADS ARE PARALLEL THREADS ACCORDING TO ISO 228/1

CROSS PANEL FITTINGS Ø 6 mm

Fittings to attach and/or protect sensor tubing through a panel.

KEY FEATURES

- Polymer construction to protect from sharp metal edges

THROUGH - PANEL FASTENER



Exerts radial compression when tightened
to securely hold tubing in place

THROUGH PANEL PROTECTOR



Protects the sensor tubing from sharp edges

Product code	B07830005	B07860001
Material	Nylon	Rubber
Orifice Diameter	Ø 0.234" / 6mm	Ø 0.25" / 6.3mm
Max. panel thickness	0.95" / 2.4mm	0.07" / 1.8mm
Length	1.18" / 30mm	0.20" / 5mm

WALL MOUNTING BRACKET

To easily attach actuators to a wall or panel. For use with all models of: end-of-line gauges, manual and solenoid actuators.



Product code	024900414
Material	Stainless steel

END OF LINE DEVICES & ACTUATORS FOR SENSOR TUBING

To seal and charge the far end of the sensor tube.

KEY FEATURES

- Nickel plated brass body
- Available in standard, quick connect or high vibration fittings
- Through-panel mounting

CHOOSE FROM 3 AVAILABLE END CONNECTIONS



Standard

Quick connect

High vibration

END OF LINE PLUG



- Basic plug to seal the end of line

END OF LINE GAUGE



- Includes: check valve, pressure gauge & fitting to connect to sensor tubing

MANUAL ACTUATOR



- Includes: pressure gauge, connection for filling adaptor and fitting to connect to sensor tubing
- Large, easily visible knob
- Yellow safety collar

PISTON BLOCK



- Includes: pressure gauge, sensor tube fitting, pressure switch port and filling adaptor port integrated in an aluminium monobloc body. Durable and corrosion-resistant piston.
- Easy installation
- No need to change diaphragm

SOLENOID ACTUATOR



- Includes: pressure gauge, connection for filling adaptor, fitting to connect to sensor tubing.
- For supplemental actuation via electronic sensor or control room

Product code					12V	24V
Quick connect fittings	029510056	B07810026	B04420128	B04420150		B04420127
Standard connections	029510010	B07810014	B04420115	B04420144	B04420095	B04420085
High vibration		B07810025	B04420143	B04420145		B04420142

Tube connection	6mm	6mm	6mm	6 mm	6mm	6mm
Length	1.13" / 29 mm	2.77" / 71 mm	4.95" / 106 mm	4.95" / 106 mm	3.9" / 100 mm	3.9" / 100 mm
Power					9W / 12 V	9W / 24 V
Gauge scale	-	0 - 20 bar	0 - 20 bar	0 - 28 bar	0 - 20 bar	0 - 20 bar
Charging port	NO	YES	YES	YES	YES	YES

G $\frac{1}{4}$ " SOLENOID ACTUATOR

For electronic actuation using a smoke detector or other electronic detection device.

KEY FEATURES

- Mounts directly on IHP cylinder valves (B0702 series) or mounts on pressure switch manifold B07850046 p.46



Product code	B04420088
Connection	G $\frac{1}{4}$ "
Power	9W / 24V
Max. working pressure	20 bar
Temperature range	-20 to + 60°C
Length	74mm

DISCHARGE TUBING & PIPING

Discharge tubing for FireDETEC® indirect systems.

STAINLESS
STEEL TUBE



STAINLESS
STEEL TUBE



BRASS TUBE



SCHEDULE 40 STAINLESS STEEL PIPE FOR CLEAN AGENT SYSTEMS



Product code	022700599	022700643	022700641	022700610	022700611	022700612	022700613
Diameter	Ø 8 mm	Ø 15 mm	Ø 8 mm	Ø ¼" / 13,7mm	Ø ⅜" / 17,1mm	Ø ½" / 21,3mm	Ø ¾" / 26,7mm
Length	1 meter	1 meter	1 meter	1 meter	1 meter	1 meter	1 meter
Fittings compatibility	single/double ring fittings	single ring fittings	bicone fittings	pipe fittings	pipe fittings	pipe fittings	pipe fittings
Thread	-	-	-	NPT	NPT	NPT	NPT

DOUBLE RING FITTINGS FOR 8mm STAINLESS STEEL DISCHARGE TUBING

Fittings to connect 8 mm stainless steel discharge tubes.

KEY FEATURES

- Double ferrule compression technology for exceptional grip even under high pressure

STRAIGHT



CROSS PANEL



ELBOW



Product code	B07835027	B07835037	B07835028
Connection	Ø 8 mm	Ø 8 mm	Ø 8 mm
Material	AISI 316L	AISI 316L	AISI 316L

TEE



STRAIGHT PIPE & NOZZLE FITTING



ELBOW NOZZLE FITTING MALE



Product code	B07835029	B07835026	B07835036
Connection	Ø 8 mm	Ø 8 mm, G ¼" male	Ø 8 mm, G ¼" male
Material	AISI 316L	AISI 316L	AISI 316L

TEE NOZZLE FITTING MALE



ELBOW NOZZLE FITTING FEMALE



for vehicle systems

TEE NOZZLE FITTING FEMALE



for vehicle systems

Product code	B07835041	B07835031	B07835030
Connection	Ø 8 mm, G ¼" male	Ø 8 mm, R ⅛" female	Ø 8 mm, R ⅛" female
Material	AISI 316L	AISI 316L	AISI 316L

STRAIGHT NOZZLE FITTING FEMALE



for kitchen systems

STRAIGHT FITTING MALE



for kitchen systems

STRAIGHT FITTING



for directional cone

NOZZLE FITTING STRAIGHT







for vehicle systems







Product code	B07835038	B07835039	B07835042	B07835047
Connection	Ø 8 mm, G ¼" female	Ø 8 mm, G ¼" male	Ø 8 mm, ½" male NPT	Ø 8 mm, ⅛" BSPT
Material	AISI 316L	AISI 316L	AISI 316L	AISI 316L

G THREADS ARE PARALLEL THREADS ACCORDING TO ISO 228/1
R THREADS ARE TAPERED THREADS ACCORDING TO ISO 7-1 AND EN10226-1

SINGLE RING FITTINGS FOR 8MM STAINLESS STEEL TUBING

Stainless steel fittings to connect to 8mm stainless steel discharge tube.	TEE	ELBOW	UNION	CROSS PANEL	NOZZLE	BRACKET
						
Product code	029170000	029160000	029510067	029510069	029510071	B07860006
Connection	Ø8mm	Ø8mm	Ø8mm	Ø8mm	Ø8mm ; G1/4" female	Ø8mm
Material	Stainless steel	Stainless steel	Stainless steel	Stainless steel	Stainless steel	PA6.6
Max. pressure	Up to 160 bar (depending on tube)					



SINGLE RING FITTINGS FOR 15 MM STAINLESS STEEL TUBING

Stainless steel fittings to connect to 15mm stainless steel discharge tube.	TEE	ELBOW	UNION	CROSS PANEL	TEE	TEE	BRACKET
							
Product code	029160001	029170001	029510068	029510070	029170003	029170002	B07860007
Connection	Ø15mm	Ø15mm	Ø15mm	Ø15mm	Ø15 - Ø8 - Ø8 mm	Ø15 - Ø8 - Ø15 mm	Ø15mm
Material	Stainless steel	Stainless steel	Stainless steel	Stainless steel	Stainless steel	Stainless steel	Steel
Max. pressure	Up to 160 bar (depending on tube)						

BICONE FITTINGS FOR 8MM BRASS DISCHARGE TUBING

Brass bicone fittings to connect to 8mm brass discharge tube.	TEE	TEE	ELBOW	ELBOW	STRAIGHT	STRAIGHT	CROSS
							
Product code	026600004	026600005	026500010	026500011	026300339	026300340	026610001
Connection	Ø8mm	Ø8mm ; G1/8"	Ø8mm ; G1/8"	Ø8mm	Ø8mm	Ø8mm ; G1/8"	Ø8mm
Material	Brass						
Max. pressure	Up to 100bar (depending on tube)						

PIPE FITTINGS FOR STEEL DISCHARGE PIPING - NPT





Fittings to connect 1/4", 3/8", 1/2" and 3/4" steel threaded piping for clean agent systems.	STRAIGHT UNION 1/4"	STRAIGHT UNION 3/8"	STRAIGHT UNION 1/2"	STRAIGHT UNION 3/4"
				
Product code	B07833001	B07833006	B07833008	B07833012
Connection	1/4" NPTF	3/8" NPTF	1/2" NPTF	3/4" NPTF
Material	Galvanized carbon steel	Galvanized carbon steel	Galvanized carbon steel	Galvanized carbon steel
	RUN UNION 1/4" TO 1/4"	RUN UNION 1/2" TO 1/2"	RUN ADAPTER 1/2" TO 3/8"	RUN ADAPTER 1/2" TO 3/4"
				
Product code	B07833002	B07833003	B07833004	B07833010
Connection	1/4" NPTM - 1/4" NPTF	1/2" NPTM - 1/2" NPTF	1/2" NPTM - 3/8" NPTF	1/2" NPTM - 3/4" NPTF
Material	Galvanized carbon steel	Galvanized carbon steel	Galvanized carbon steel	Galvanized carbon steel

	ELBOW UNION 1/4"	ELBOW UNION 3/8"	ELBOW UNION 1/2"	ELBOW UNION 3/4"
				
Product code	B07833000	B07833005	B07833007	B07833011
Connection	1/4" NPTF	3/8" NPTF	1/2" NPTF	3/4" NPTF
Material	Galvanized carbon steel	Galvanized carbon steel	Galvanized carbon steel	Galvanized carbon steel

	TEE UNION 1/2"	TEE UNION 3/4"	STRAIGHT ADAPTER 3/4" TO 1/2"
			
Product code	B07833022	B07833023	B07833014
Connection	3/8"-1/2"-3/8" NPTF	1/2"-3/4"-1/2" NPTF	3/4" NPTF male - 1/2" NPTF female
Material	Stainless steel 316	Stainless steel 316	Galvanized carbon steel

DISCHARGE HOSES

To connect discharge tubing to the cylinder valve assembly in FireDETEC® systems.

	CO ₂ SYSTEM HOSE	KITCHEN SYSTEM HOSE 9L	KITCHEN SYSTEM HOSE 16-25L	VEHICLE ENGINE SYSTEM HOSE
				
Product code	B06920006	022720040	022720044	022720039
Length	800 mm	600 mm	600 mm	1250 mm
Cylinder connection	W21.8 x 1/4"	8X1 Tube adapter	1/2" 14 NPT	8X1 Tube adapter
Tube connection	Ø 8x1mm Tube fitting	Ø 8x1mm Tube adapter	Fitting for Ø 15 mm tube	Ø 8x1mm Tube adapter
Material	Oil resistant & weatherproof synthetic rubber	Stainless steel	Stainless steel	Stainless steel
Max. working pressure	300 bar at 20°C	220 bar at 20°C	100 bar at 20°C	220 bar at 20°C

MOUNTING BRACKETS FOR DISCHARGE TUBING & PIPING

To secure discharge tubing in place.

					
Product code	B07860006	B07860007	B07860008	B07860009	B07860010
for tubing	Ø 8 mm	Ø 1/4"	Ø 3/8"	Ø 1/2"	Ø 3/4"
material	PA 6.6	steel	steel	steel	steel

DIRECTIONAL VALVE KIT

Ready-to-install assembly of directional valve + fittings to create separate protection zones within the same cylinder/valve system.

One directional valve is needed for each individual protection zone.

DOUBLE-RING HIGH PRESSURE

For 8 mm stainless steel discharge tubing



Product code	B07060003
Sensor tube connection	6 mm Quick Fit
Discharge tube connection	8 mm double-ring fitting
Max working pressure	250 bar

DISCHARGE NOZZLES

Dispersion nozzles for FireDETEC® systems.

3 HOLE NOZZLE

CO₂ and inert gas



DIRECTIONAL CONE

CO₂ and inert gas



DIRECTIONAL CONE WITH FLANGE

CO₂ and inert gas



Product code	026200116	B06960031	B06960032
Orifice	3 holes x 2 mm	4 holes x 2 mm	4 holes x 2 mm
Dimensions	Ø16 mm x 25 mm	Ø80 mm x 92 mm	Ø100 mm x 92 mm
Connection	G 1/4 female	G 1/2"	G 1/2"
Material	Stainless Steel 303	Nickel-plated brass + aluminum	Nickel-plated brass + aluminum

KITCHEN NOZZLE

Class F Liquid agent



VEHICLE NOZZLE

Liquid agent



POWDER NOZZLE

Powder



Product code	026200117	026205098	026200132
Orifice	1 hole x 2.7 mm	1 hole x 2 mm	13 holes x 1.5 mm
Dimensions	Ø13.5 mm x 25 mm	Ø10 mm x 22 mm	Ø19 mm x 24 mm
Connection	R1/4" male	R3/8" male	G1/4" female
Material	Stainless Steel	Stainless Steel	Nickel-plated brass

3 LB. KIT

7 LB. KIT

7 LB. KIT

14 LB. KIT

14 LB. KIT

FM-200®

FM-200®

FM-200®

FM-200®

FM-200®



1 Nozzle configuration

1 Nozzle configuration

2 Nozzle configuration

1 Nozzle configuration

2 Nozzle configuration

Product code	026200102	026200104	026200103	026200107	026200105
Connection	1/4" NPT	3/8" NPT	3/8" NPT	1/2" NPT	1/2" NPT
Orifice Diameter	0.085"	0.138"	0.085"	0.200"	0.138"
Number of orifices	8	8	8	8	8
Nozzle Pressure	32.7 psi	48.6 psi	57.7 psi	53.7 psi	56 psi
Discharge time	8.7 seconds	8.8 seconds	8.2 seconds	7.5 seconds	7.6 seconds
Nozzle O.D.	Ø: 0.74" / 19 mm	Ø: 0.875" / 22,5 mm	Ø: 0.875" / 22,5 mm	Ø: 0.975" / 25 mm	Ø: 0.975" / 25 mm
Material	Raw Brass	Raw Brass	Raw Brass	Raw Brass	Raw Brass

3 LB. KIT

7 LB. KIT

7 LB. KIT

14 LB. KIT

14 LB. KIT

Novac 1230 Fluid

Novac 1230 Fluid

Novac 1230 Fluid

Novac 1230 Fluid

Novac 1230 Fluid



1 Nozzle configuration

1 Nozzle configuration

2 Nozzle configuration

1 Nozzle configuration

2 Nozzle configuration

Product code	026200110	026200111	026200106	026200108	026200109
Nozzle Diameter	1/4" NPT	3/8" NPT	3/8" NPT	1/2" NPT	1/2" NPT
Orifice Diameter	0.063"	0.063"	0.049"	0.109"	0.049"
Orifice Quantity	12	16	12	24	24
Nozzle Pressure	34.5 psi	43.0 psi	41.8 psi	30.1 psi	45.7 psi
Discharge time	6.3 seconds	9.1 seconds	6.0 seconds	6.7 seconds	6.3 seconds
Nozzle O.D.	Ø: 0.74" / 19 mm	Ø: 0.875" / 22,5 mm	Ø: 0.875" / 22,5 mm	Ø: 0.975" / 25 mm	Ø: 0.975" / 25 mm
Material	Raw Brass	Raw Brass	Raw Brass	Raw Brass	Raw Brass

DIMES CONTROL & ALARM BOX

Control Box with Alarm for DIMES system.



Product code | B07850201

KEY FEATURES

- Power supply: 230 V AC
- Protection IP 40
- Battery backup: 12 V – 1,2 Ah
- 3 Inputs / 1 Output

DIMES CALIBRATION UNIT

Digital display and calibration device for DIMES digital measurement system.



Product code | B07850200

KEY FEATURES

- Calibrates valve to cylinder and saves data via a built-in microchip
- Digital display can also be used to monitor system

DIMES CONNECTOR CABLE

To connect the DIMES valve to a DIMES Alarm Box.







Product code | 029900088

KEY FEATURES

- 8 Pin connection
- 2 meter long cable

PRESSURE SWITCHES

For supplemental functionalities when the system actuates such as sounding an alarm, closing ventilator ducts or cutting power supply.

	5 BAR	12 BAR	160 BAR	11 / 12 BAR
				
	For discharge detection	For leak detection		For use with FM Approved ILP Systems
Product code	028255048	028255059	028255047	029900168
Switch type	SPDT	SPDT	SPDT	SPST
Fixture	M10 x 1	M10 x 1	M10 x 1	M10 x 1
Type	NO / NC	NO / NC	NO / NC	Normally open
Electrical rating	V max: 240V I max: 3A	V max: 240V I max: 3A	V max: 240V I max: 3A	120 / 240 VAC - 375 VA 24 VAC - 125 VA
Operation	5 bar ± 0.5 bar	12 bar ± 0.5 bar	160 bar ± 1,3 bar	Open 160 psi ± 7 Close 185 psi ± 5
Max pressure	60 bar	60 bar	350 bar	27 bar / 400 psi
Connection	DIN EN 175301-803	DIN EN 175301-803	DIN EN 175301-803	
O-ring material	EPDM	EPDM	EPDM	NBR

PRESSURE SWITCH

Detects when the system discharges and sends an electronic signal for a secondary function, such as sounding an alarm, cutting power supply or turning off ventilation air flow.

	
Product code	028250050
Opening Pressure	2 bar
Connection	G ½"
Power source	400 VAC / 3A or 24 VAC / 10 A
Protection	IP65

ADAPTER FOR PRESSURE SWITCH

B07835045
8 mm double ring fitting – G ½"
Stainless Steel

ALARMS

Audio alarm for connection to pressure switches to warn if system actuates, or if system depressurizes due to leak.

	ALARM 9 V DC BATTERY
	
Product code	B07850043
Audible signal	100 db
Power supply	9V Carbon zinc battery
Dimensions	115x136x53 mm

DASHBOARD WARNING DEVICE

Accessory for the COMPACT LINE® Vehicle Engine System to warn the driver in the event of a fire, or a system leak.

Mounts in the driver cabin of any vehicle.

KEY FEATURES

- Delivers visual and audio warning to vehicle driver
- 3 warning lights to indicate system status:
 - Green = System OK
 - Yellow = Error – System needs service
 - Red = System discharge – stop & evacuate
- Robust aluminum casing for long service lifetime



Product code	B07850302
Power supply	12VDC to 24VDC
Temperature range	-40°C to +65°C
Electrical Connectors	Superseal cap housing, 2 positions (power); Superseal plug housing, 4 positions (sensors); Superseal plug housing, 2 positions (alarm)
Wire	Section 0,35mm ²
Dimensions	124,5 x 50 x 27 mm

CYLINDER MOUNTING BRACKETS - CO₂

To mount all FireDETEC® CO₂ Cylinder / Valve 2/5/10 Kg. kits.

CYLINDER Ø 108 mm

For 2Kg. cylinders



CYLINDER Ø 140 mm

For 5Kg. cylinders



CYLINDER Ø 140 mm

For 10Kg. cylinders tall



CYLINDER Ø 204 mm

For 10Kg. cylinders short



Product code	024900399	024900390	024900422	024900395
Diameter	Ø 108 mm	Ø 140 mm	Ø 140 mm	Ø 204 mm
Height	373 mm	493 mm	930 mm	413 mm
Depth	145 mm	170 mm	170 mm	235 mm
Material	Powder-coated Steel	Powder-coated Steel	Powder-coated Steel	Powder-coated Steel
Weight	1.5 Kg.	2 Kg.	2 Kg.	2 Kg.

WALL MOUNTING RAIL - CO₂

Wall mounting rail for 20Kg. and 30Kg. CO₂ cylinders.



KEY FEATURES

- Galvanized steel components for solid support and a long service lifetime



1	WALL MOUNTING RAIL	2	CLAMP FOR CYLINDER	3	END CAP FOR MOUNTING RAIL AND BRACKET
Input	Length L	Product code	Diameter	Product code	Product code
1 cylinder	400 mm	024900311	203-212 mm	024900424	024900322

CYLINDER MOUNTING OPTIONS - KITCHEN SYSTEM

To mount the TRIPLESTAR Kitchen cylinder/valve assembly.

FOR 9L SYSTEM



Product code	024900401
Diameter	180 mm
Height	465 mm
Depth	213 mm
Width	-
Material	Powder-coated steel
Weight	2 Kg.

Stainless steel components for solid support and a long service lifetime

FOR 16 OR 25L SYSTEMS



1

WALL MOUNTING RAIL

Input	Length L	Product code
1 cylinder	350 mm	024900338

2

CLAMP FOR CYLINDER

Diameter	Product code
250-263 mm	024900451

3

END CAP FOR MOUNTING RAIL AND BRACKET

Product code
024900322

Protective cabinet helps keep the cylinder/valve assembly clean and protects the valve from impact.

PROTECTIVE CABINET



	9L	16L	25L
Product code	029840030	029840030	029840030
Diameter	-	-	-
Height	750 mm	750 mm	1000 mm
Depth	250 mm	450 mm	450 mm
Width	350 mm	400 mm	400 mm
Material	Stainless Steel	Stainless Steel	Stainless Steel
Weight	4 Kg.	6 Kg.	9 Kg.

BLOCKING VALVE UNIT

Solenoid blocking valve unit to prevent the FireDETEC system actuation during object maintenance (cleaning, repairs, settings).



KEY FEATURES

- To mount along your FireDETEC detection line
- Commonly use with CNC machines (ISO 19353 EN)
- Fittings not included

Product code	B05513010
Port	2 x G1/8"
Voltage / power	24 VDC / 11 W

CHECK VALVE FOR SENSOR TUBING

Prevents backwards flow of gas when pressuring sensor tubing.



Only for use when filling sensor tubing

Product code	B07810011
Connection	G1/8" female
Material	Nickel-plated brass

PRESSURE GAUGES

Optional and spare pressure gauges.

PRESSURE GAUGE WITH CONTACT SWITCH



PRESSURE GAUGE FOR FM-200® AGENT



PRESSURE GAUGE FOR NOVEC™ 1230 FLUID



PRESSURE GAUGE FOR KITCHEN SYSTEMS



PRESSURE GAUGE FOR VEHICLE SYSTEMS



Product code	029720096	028200190	028200191	029720111	029720059
Suppression agent	Chemical gas or Inert gas	FM-200®	NOVEC™ 1230	FireDETEC F/K®	Inert gas
Connection	M10 x 1	1/8" NPT	1/8" NPT	M10 x 1	M10 x 1
Scale	0 - 20 bar	0 - 500 psi	0 - 400 psi	0 - 28 bar	0 - 350 bar
Dimensions	Ø 40 mm	Ø 37,5 mm	Ø 37,5 mm	Ø 23 mm	Ø 39 mm
Preset pressure	5-7 bar normally closed	-	-	-	-

FIREDETEC® EXTINGUISHING AGENT REFILL

Refill canisters of
extinguishing agent for
specialty applications.

FIREDETEC® F/K



9 LITERS



16 LITERS



25 LITERS

Product code	020080157	020080164	020080156
Extinguishing agent	FireDETEC® F/K		
Applications	For commerical kitchen systems		

FIREDETEC® TS-55



4 LITERS



7 LITERS



12 LITERS



25 LITERS

Product code	020080163	020080158	020080162	020080152
Extinguishing agent	FireDETEC® TS-55			
Applications	For vehicle engine system			

CYLINDER LABELS LANGUAGE PACKS

- Spare labels for FireDETEC® System cylinders in various languages
- Labels are specific to the extinguishing agent being used



Labels are only valid for systems configured entirely with FireDETEC components.

CO₂

Indirect



Direct



TRIPLESTAR KITCHEN SYSTEMS



COMPACT LINE® VEHICLE SYSTEMS

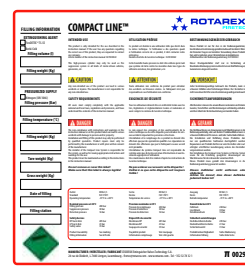

Language	ALL SIZES	ALL SIZES	ALL SIZES	ALL SIZES
English	028000082	028000084	028000091	028000200
French	028000114	028000163	028000150	028000200
German	028000115	028000164	028000151	028000200

Others languages available on demand

HFC 227 EA - CE-APPROVED CYLINDER

INDIRECT SYSTEMS (ILP)

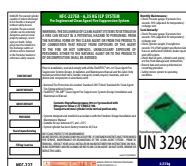

DIRECT SYSTEMS (DLP)



Language	1,36 KG.	3,18 KG.	6,35 KG.	1,36 KG.	3,18 KG.
English	028000253	028000257	028000261	028000265	028000266
French	028000254	028000258	028000262	028000217	028000226
German	028000255	028000259	028000263	028000218	028000227

Others languages available on demand

ABC DRY CHEMICAL SYSTEM LABELS

Spare part labels for FireDETEC® ABC dry chemical systems

- Standardly available in English. Other languages available on demand

INDIRECT SYSTEMS (ILP)

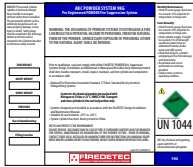
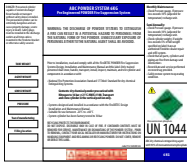
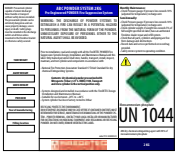

Language	2 KG	6KG	9KG
English	028000325	028000326	028000327

Others languages available on demand

WARNING LABEL SETS

- Auto-adhesive safety stickers

FOR ALL SYSTEMS

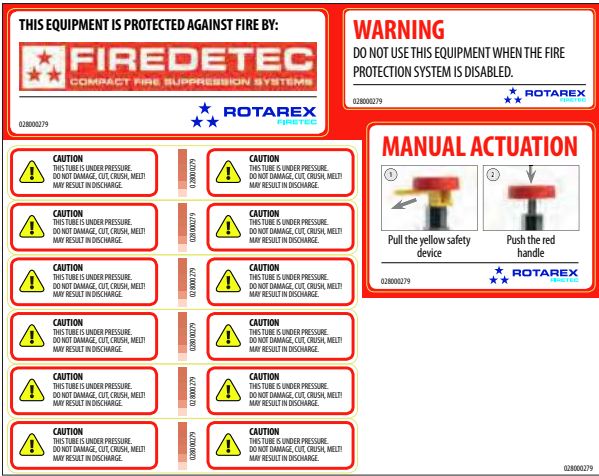

Language	
English	028000279
French	028000280
German	028000281
Contains	6 tube warning stickers 1 actuator instruction 1 "equipment protected" sticker 1 disabled warning sticker

Others languages available on demand

INSTALLATION TOOLS

Specialized tools to facilitate easier installation of FireDETEC® systems.

SENSOR TUBE CUTTER



Razor pinch cutter for clean, square edges

SENSOR TUBE GRIPPING TOOL



Flexible rubber pad to grip sensor tubing

Product code

B07850001

024920014

SENSOR TUBE FILLING ADAPTOR

Allows connection of a charging cartridge to an end-of-line device to pressurize the sensor tube.



KEY FEATURES

- Includes: Protective Spring top and connector
- Standard fittings

Product code	B07810005
Extinguishing agents	Water, powder and chemical
Working Temperature	- 20°C to +60°C
Working Pressure	10 to 18 bar
Connection	M10x1

SENSOR TUBE 2,7 L FILLING KIT

Used to pressurize FireDETEC® sensor tubing.

KEY FEATURES

- HP cylinder / Valve kit with sensor tube + fitting adaptor
- Available filled or unfilled

	UNFILLED	FILLED
Product code	B07502000	B07502500
Pressure	200 bar	200 bar
Outlet pressure	16 bar	16 bar
Weight	6,5 Kg.	7,1 Kg.



COMPACT LINE® 10L FILLING KIT

Used to pressurize the COMPACT LINE® High Pressure chamber.

KEY FEATURES

- HP cylinder / Valve kit with high pressure safety cable and filling adaptor
- 200 bar Pressure regulator
- Available filled or unfilled

	UNFILLED	FILLED
Product code	B07502007	B07502507
Pressure	300 bar	300 bar
Outlet pressure	200 bar	200 bar
Weight	16,5 Kg.	21,3 Kg.



SENSOR TUBE FILLING / DEMO KIT

Used to pressurize FireDETEC® sensor tubing or to demo the sensor tubing function.



UNFILLED

FILLED

Product code	B07502002	B07502502
Cylinder Pressure	150 bar	150 bar
Outlet pressure	16 bar	16 bar
Dimensions	Ø 50 x 314 mm	Ø 50 x 314 mm

KEY FEATURES

- Available filled or unfilled
- Comes in a carrying case
- Kit contains:
 - 0.2 liter cylinder
 - Valve with pressure gauge and ball valve
 - Tube cutter
 - Filling adaptor
 - Sensor tubing
 - End plugs
 - Lighter

END OF LINE SPARE PARTS

Replacement part for FireDETEC® actuators.

GAUGE + GASKET



SAFETY COLLAR



DIAPHRAGM FOR MANUAL ACTUATORS



For B04420128, B04420115, B04420143 models

Product code	029720086	026800016	029205000
--------------	-----------	-----------	-----------

CYLINDER MOUNTING BRACKETS - HFC-227 ea

Spare part brackets to mount HFC 227 ea FireDETEC® cylinder kits.

KEY FEATURES

- Black powder-coated steel holder
- Stainless steel adjustable straps



Different codes for DOT or CE systems

3 LB. / 1,36 Kg.



DOT

CE

7 LB. / 3,18 Kg.



DOT

CE

14 LB. KIT / 6,35 Kg.



DOT

CE

Product code	029900169	029900192	029900171	029900193	029900170	029900194
Weight	1.2 lbs / 0,55 Kg.	1.2 lbs / 0,55 Kg.	1.2 lbs / 0,55 Kg.	1.2 lbs / 0,55 Kg.	3.6 lbs / 1,7 Kg.	1.2 lbs / 0,55 Kg.
Height	11.7" / 300 mm	10.2" / 260 mm	11.7" / 300 mm	11.4" / 290 mm	12.48" / 320 mm	13.8" / 350 mm
Depth	3.22" / 85 mm	4.3" / 108 mm	3.22" / 85 mm	5.6" / 143 mm	4.49" / 115 mm	7.0" / 178 mm
Width	1.95" / 50.8 mm	1.2" / 30,5 mm	1.95" / 50.8 mm	1.2" / 30,5 mm	4.49" / 115 mm	1.2" / 30,5 mm

BALL VALVES FOR SENSOR TUBING

Low pressure Ball Valve for FireDETEC® sensor tubing.



Product code	B07840004	B07840003
Inlet	male G1/4"	male G1/8"
Outlet	female G1/8"	female G1/8"

BALL-VALVE SECURITY LOCK

Safety device for preventing unintentional opening of the valve of the bottle during storage, transportation and installation. Can also be used to lock the valve in the open position when installed and armed.

Tamper evident security seal on the optional

SECURITY CLIP



CONTACT REED KIT

Electromagnetic contact sensor
Connect to control box B07850201



TAMPER-EVIDENT SEAL

Product code	026800040	029930000	027200007
Material	PP	Plastic and aluminium with electromagnetic sensor and wiring	PE

GASKETS

Spare part gaskets for air-tight seals.

STEEL JOINT NITRILE BOND



STEEL JOINT NITRILE BOND



FIBER JOINT



Product code	024100034	024100037	024100013
Diameter	For G1/8" thread	For G1/4" thread	External: Ø 18 mm Internal: Ø 11,8 mm

PRESSURE RELIEF DEVICE

Spare Pressure Relief Device for Clean Agent Systems using FireDETEC® valve series B0701 & B0700.

G THREADS ARE PARALLEL THREADS ACCORDING TO ISO 228/1



CE

DOT

	For all CE cylinders	3lb	7lb - 14lb
Product code	029200091	029200091	029200088
Thread connection	G 1/4"	G 1/4"	G 1/4"
Burst pressure	480 psi/33bar	480 psi/33bar	600 psi/47bar

PROTECTION CAP

To protect the valve from impact.

According to EN ISO 11117



KEY FEATURES

- For CO₂ systems only
- Max cylinder weight (filled) : 60 Kg. / 132 lbs.

Product code	B06200001
Height	184 mm
Connection	W 80 x 1/11"

SPARE PARTS FOR VEHICLE ENGINE SYSTEMS

★★ COMPACT LINE

- Spare part components for the COMPACT LINE® Vehicle Engine System.

FILLING ADAPTER G 1/4"



HOLLOW SCREW



BURST DISC



Product code	029510053	023107028	022500006
	G 1/4"	M18 x 1,5	Ø 14 mm

OUTLET ADAPTER



O-RING FOR OUTLET ADAPTER



BLEED VALVE



Product code	026307280	024000357	029900150
	M18 x 1,5 / G1/4"	fits item 026307280	6 1/8"

VENTING TOOL

PLUG FOR FireDETEC
TUBE FITTING

VEHICLE NOZZLE PROTECTION CAP



Product code	029900155	B07830031	028400093
	LP side	When not in use	Silicon

INSTALLATION GUIDELINES



EQUIPMENT NEEDED:

- The FireDETEC® Kit
- Sensor Tubing
- Discharge Tubing
- Mounting Clips
- End of Line Device
- Tube fittings
- Drill
- Screwdriver
- Wrenches
- Tube Cutter
- Tube Bender
- Filling Adaptor
- Dry Nitrogen cylinder with regulator



Installation should only be done by qualified, trained personnel.

EASY 3 STEP INSTALLATION



Always refer to respective installation manuals.

1. MOUNTING THE CYLINDER

Fix the bracket to a bulkhead, structural column or deck using four (4) ¼" bolts. Once cylinder is in place, tighten the bands so that the cylinder is secure. Orient the cylinder in the vertical position with the valve facing up and the gauge facing out and away from the wall for ease of inspection. The label and gauge must be clearly visible.



2. INSTALLING THE SENSOR TUBING

Because the tube is heat sensitive, it should always be placed above the potential fire source. For small enclosures, the tubing should be installed on the enclosure roof. Be careful not to kink or crush the sensor tube. The minimum bend radius is 4 inches / 100 mm for red tubing and 6 inches / 150 mm for black and grey tubing. Install clips every 18 inches / 450 mm (10 inches / 250 mm for direct systems) to hold tubing in place.



3. PRESSURIZING THE FIREDETEC® SENSOR TUBING

Charge the tube to 16 bar (240 psi) by connecting a dry nitrogen cylinder with a regulator to the filling adaptor, attached to the far end of the sensor tube. Test for leaks.



NOTES

A FULL LINE OF GAS CONTROL SOLUTIONS



COMPLETE SOLUTIONS FROM SOURCE TO PROCESS.

ROTAREX is helping engineers worldwide to get better gas results: from ultra high purity production and medical care facilities to industrial and LPG applications, as well as alternative energy vehicles, fire suppression, diving, aerospace, cryogenics, laboratory, petro-chemical and welding. ROTAREX applies over 90 years of know-how and experience to custom design, develop and manufacture the high performance valves, regulators and fittings to suit your needs, all in one hand. Discover the difference ROTAREX can make in your world.

CYLINDER VALVES

EQUIPMENT

FIRETEC

AUTOMOTIVE

LPG/SRG

MEDITEC



ULTRA HIGH PURITY VALVES



MEDICAL VALVES & EQUIPMENT



INDUSTRIAL CYLINDER VALVES



REFRIGERANT CYLINDER VALVES



PRESSURE REGULATORS



SUPPLY & SWITCH OVER BOARDS



LINE VALVES



FITTINGS & ADAPTORS



**FIXED INSTALLATION
FIRE SYSTEMS**



**OBJECT FIRE SUPPRESSION
SYSTEMS**



**AUTOMOTIVE VALVES
& REGULATORS**



WATER CARBONATION



**LPG TANK VALVES
& REGULATORS**



**LPG CYLINDER VALVES
& REGULATORS**



**DIGITAL MEASUREMENT
SYSTEMS**



PLASTIC INJECTION MOULDING

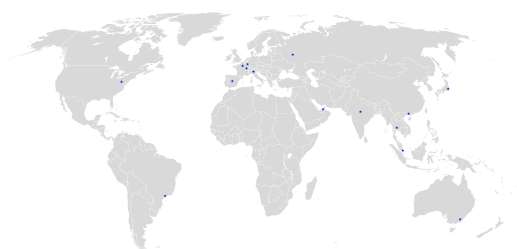

WORLDWIDE HEADQUARTERS

ROTAREX S.A.
24, rue de Diekirch,
L-7440 Lintgen
Luxembourg
Tel.: +352 32 78 32-1
Fax: +352 32 78 32-854
E-mail: firetec@rotarex.com



REGIONAL / COUNTRY HEADQUARTERS

NORTH AMERICA

USA
Rotarex North America
Hackettstown
E-mail: northamerica@rotarex.com

SOUTH AMERICA

BRASIL
Rotarex Brazil Ltda
São Paulo
E-mail: brasil@rotarex.com

CENTRAL AMERICA

MEXICO
Rotarex México
Mexico City
E-mail: mexico@rotarex.com

EUROPE

EUROPEAN HEADQUARTERS
Rotarex S.A. Luxembourg
24, rue de Diekirch,
L-7440 Lintgen, Luxembourg
Tel.: +352 32 78 32-1
E-mail: firetec@rotarex.com

ITALY

Rotarex Italia S.r.l.
Ciliverghe di Mazzano
E-mail: italia@rotarex.com

SPAIN

Rotarex Spain
Madrid
E-mail: spain@rotarex.com

FRANCE

Rotarex France
Paris
E-mail: france@rotarex.com

RUSSIA

Rotarex Rus
Moscow
E-mail: russia@rotarex.com

POLAND

Rotarex Polska
Brzeg
E-mail: polska@rotarex.com

ASIA - PACIFIC

SINGAPORE

Rotarex Fareast Pte Ltd
Singapore
E-mail: fareast@rotarex.com

CHINA

Rotarex Star
Shanghai
E-mail: china@rotarex.com

JAPAN

Rotarex Japan Ltd
Tokyo
E-mail: japan@rotarex.com

INDIA

Rotarex ENGG. PVT. LTD.
Mumbai
E-mail: india@rotarex.com

THAILAND

Rotarex (Thailand) Co Ltd.
Pakkret
E-mail: thailand@rotarex.com

TAIWAN

Rotarex Taiwan
New Taipei City
E-mail: taiwan@rotarex.com

MALAYSIA

Rotarex Malaysia
Kuala Lumpur
E-mail: malaysia@rotarex.com

PHILIPPINES

Rotarex Philippines
Manila
E-mail: philippines@rotarex.com

INDONESIA

Rotarex Indonesia
Jakarta
E-mail: Indonesia@rotarex.com

MIDDLE EAST / AFRICA

MIDDLE EAST

Rotarex Middle East
Dubai
E-mail: middle-east@rotarex.com



For more contact details go to
www.rotarexfiretec.com/locations